

Promat

by etex

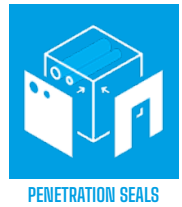

PROMASEAL[®] HPE Sealant

Fire Resistant Intumescent Sealant



PROMASEAL® HPE Sealant

Fire Resistant Intumescent Sealant

General Description

PROMASEAL® HPE is a fire resistant, intumescent sealant for interior penetration seals. It is designed to provide a high-volume expansion and pressure seal during a fire, for areas where combustible services penetrate apertures in floors and walls that are designed to provide compartmentation.

Packaging

- 600ml foil pack - 12 per box
- 310ml cartridge - 12 per box

Application and use

Reinstates the fire resistance performance in a wall or floor around combustible penetration services. PROMASEAL® HPE can be used in conjunction with various substrates,

Installation & Operation

The installation of Promat products is recommended to be carried out by experienced fire protection installers.

The substrate must be clean, dry, and homogeneous, free from oils, grease, dust and loose particles. The product does not require a primer on most common surfaces, although adhesion tests are recommended prior to full scale application.

Product Details	
Material	Graphite based PVA / acrylic intumescent sealant
Weight	~1.35g/cm ³
Finish / Colour	Anthracite grey, matt finish
Shelf life	18 months if stored in accordance with storage conditions
Sag Flow	~0 mm (WI 018)
Skin Time	~40 minutes (23°C/50% r.h)
Shore A Hardness (28 Days)	85/81 (1 Second/5 Seconds) (BS ISO 7619-1:2010)
Chemical Resistance / Limitations	Not to be used where material is to be constantly immersed in water. Do not use on substrates that are likely to release solvents, oils or plasticizers. Not resistant to water, strong acids, strong bases, oxidizing agents (i.e. hydrogen peroxide), alcohols, hydrocarbon solvents

Adequate space and accessibility should be provided for applying and tooling the sealant.

The substrate depth should be able as to provide a minimum sealant depth required as shown.

The sealant should be gunned firmly into the aperture ensuring that it is in full contact with the sides of the aperture and service. Failure to carry this out may result in poor adhesion or incorrect volume of sealant and failure of the system.

Tooling of the sealant may be necessary to achieve an acceptable appearance. This is accomplished by using a flat tool over the surface of the sealant to produce a smooth neat finish. Tooling also compresses the sealant into the aperture enhancing the adhesion.

Clean all tools and application equipment with water immediately after use.

Maintenance

Inspections should be completed and recorded by suitably competent individuals at intervals outlined in the operation and maintenance manual relevant to the building.

Ensure Safe Access and Egress when carrying out maintenance or inspection.

Where product (s) is damaged or tampered, new product should be installed in line with installation guidance.

Handling & Storage

For unopened material, store in a well-ventilated, dry, cool environment. Recommended temp ranges +5°C - +35°C. Protect against exposure to direct sunlight. Always ensure that safe manual handling procedures are followed at all times.

For information and advice on the safe handling, storage and disposal of chemical products, please refer to the most recent Safety Data Sheet (SDS) available at www.promat.com.au

Disposal

Removal and disposal of cured product must be done in a way that limits, as much as possible, the formation of dust. Adequate PPE must be worn including suitable respiratory equipment in the case of insufficient ventilation.

Disposal of waste sealant must be done according to official regulations and in accordance with a licensed collector's sorting instructions.

Legal Notes

Promat products are manufactured to rigid standards of quality. Any product which has been applied in accordance with Promat Australia's written instructions and in any application recommended by Promat Australia, but which is proved to be defective in product quality, will be replaced free of charge. No liability can be accepted for the information provided in this document although it is published in good faith and believed to be correct at time of issue. Any drawings provided are for illustrative purposes only. Promat Australia reserves the right to alter product specifications without prior notice, in line with our Company policy of continuous development and improvement. Changes due to

new findings are possible, errors and misprints are not excluded. No liability whatsoever will be accepted for any loss, damage or injury arising from the use of the information given. Promat Australia have no control over the methods of installation, competence of operatives or suitability of site conditions, no warranties, expressed or implied, are intended to be given as to the actual performance of the product/system mentioned within this document.v

v

SKU Codes				
Item Code	Description	Size	Colour	Box Qty
4093927	PROMASEAL® HPE Sealant	600ml Foil	Grey	12
4094841	PROMASEAL® HPE Sealant	310ml Cartridge	Grey	12

Service Separation Details

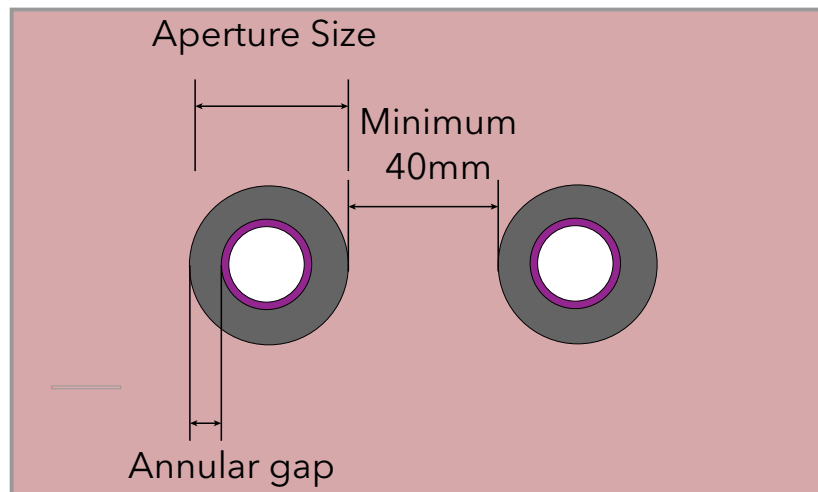

Flush Finish Elevation

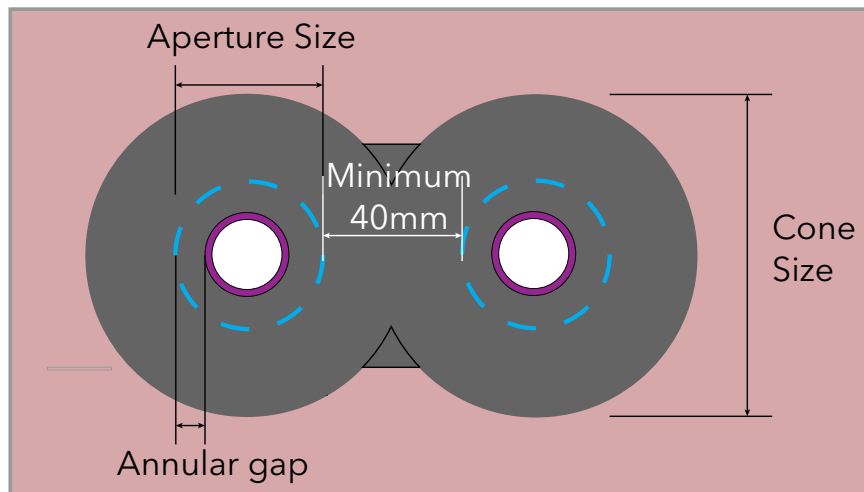

Cone Finish Elevation

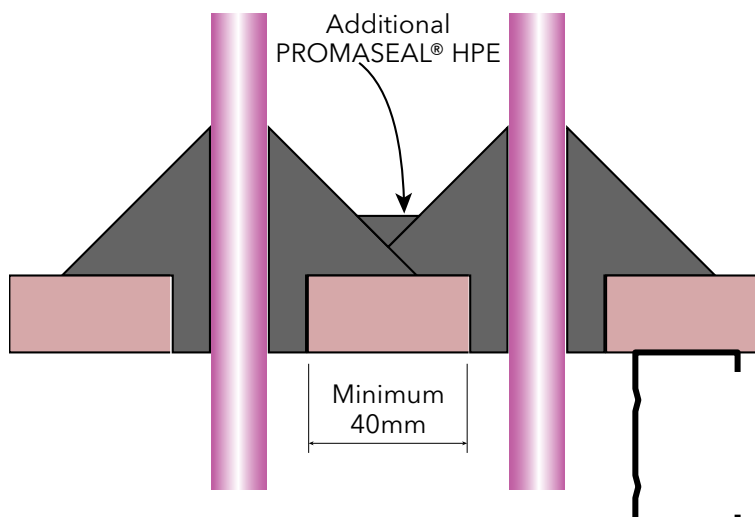

Cone Finish Plan

PROMASEAL® – HPE Sealant

Fire Resistant Plasterboard - 1 hour

1x13mm fire rated plasterboard on both sides of minimum 64mm steel stud



Assessment 250411 Tables 17,18,39 & 40

SERVICE	MAXIMUM APERTURE SIZE (mm)	MAXIMUM ANNULAR GAP (mm)	METHOD		FRL
			Flush finish	Cone / Fillet finish	
16mm PEX/AL/PEX	27	5	✓		-/60/60
20mm PEX/AL/PEX	30	5		✓	-/60/60
20mm PEX/AL/PEX	30	5	✓		-/60/45
25mm PEX/AL/PEX	35	5		✓	-/60/60
25mm PEX/AL/PEX	35	5	✓		-/60/45
32mm PEX/AL/PEX	44	5		✓	-/60/60
32mm PEX/AL/PEX	44	5	✓		-/60/15
16mm PEX	27	5	✓		-/60/60
20mm PEX	30	5	✓		-/60/60
25mm PEX	35	5	✓		-/60/60
Up to 19 x CAT 6 / Data cables	50	10		✓	-/90/90*
Up to 21 x 1.5mm alarm/fire cables	50	10		✓	-/90/90*
Pair Coil Bundle (cable + PVC drain)	121	10		✓	-/90/90*
Up to 2x 20mm conduit with TPS & CAT 6	60	10		✓	-/90/90*
Up to 30 x 2.5mm TPS / Electrical Cables	80	10		✓	-/60/60
Up to 23 x NBN / Fibre Optics Cables	60	10		✓	-/90/90*

- * FRL of -/90/90 only achieved where the plasterboard/masonry wall has an established FRL of -/90/90.
- > Can be applied into timber framed walls provided the aperture is located at least 100mm from the stud.
- > Can be applied to concrete or masonry wall with minimum thickness of 90mm.
- > If number of cables in a bundle is decreased then annular gap size must be maintained by reducing aperture size
- > Services can be installed off centre of the aperture provided the annular gap is maintained and maximum aperture size not exceeded
- > Services can be installed at an angle, provided annular gap and aperture size are maintained.

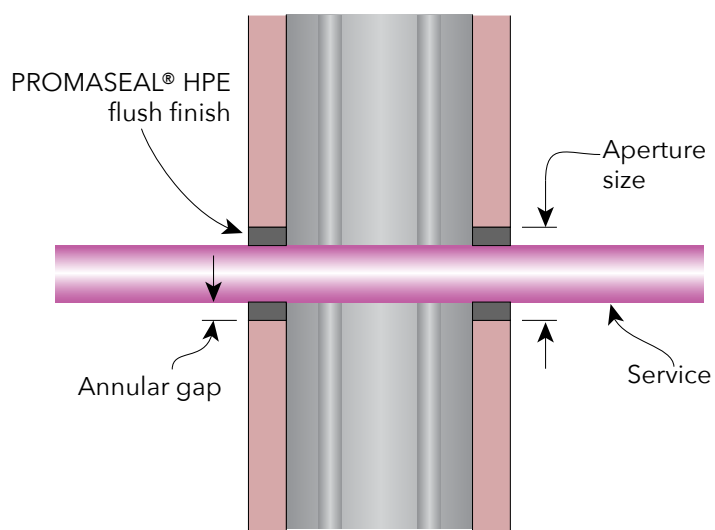

Pipe Flush Installation - Section

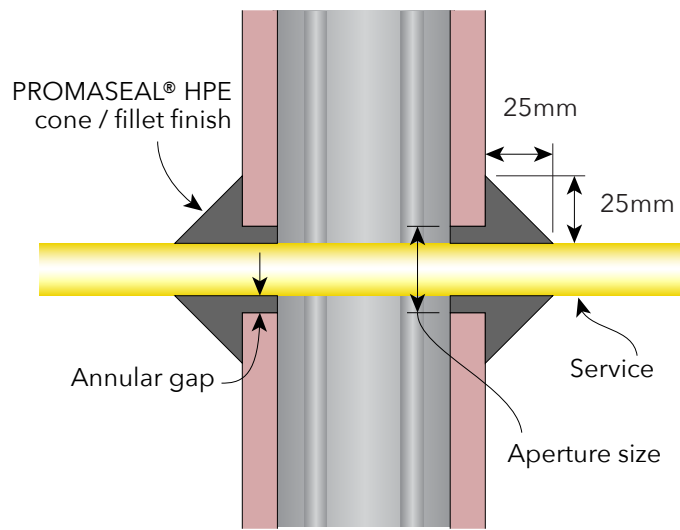

Pipe Cone/Fillet Installation - Section

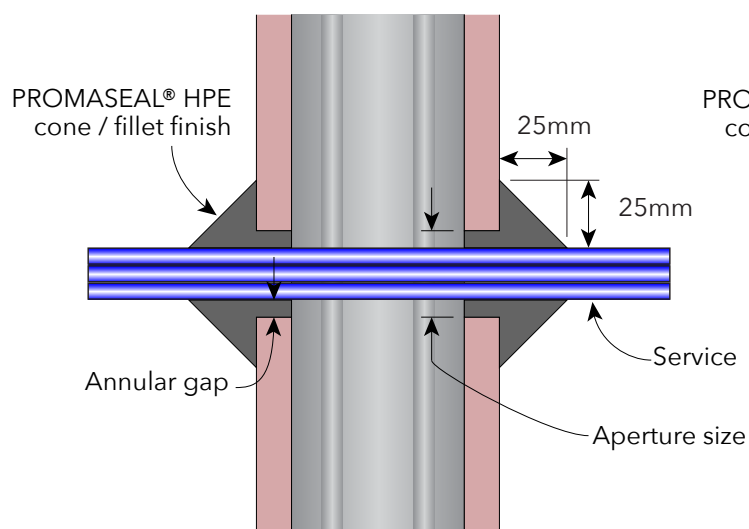

Cable Cone/Fillet Installation - Section

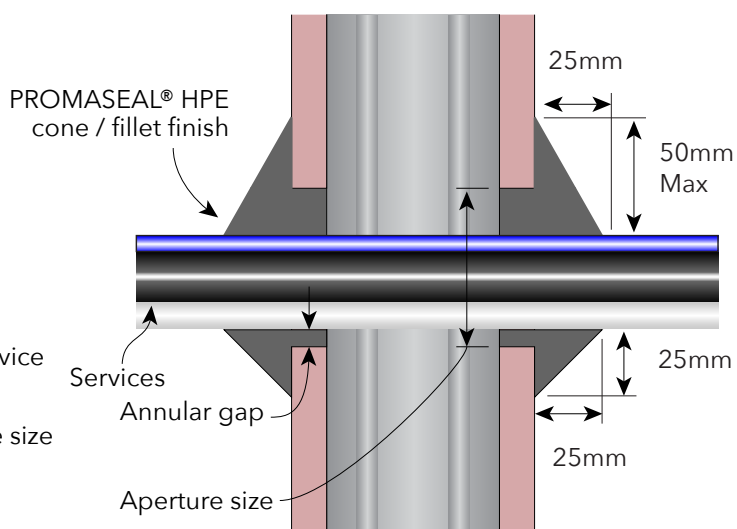

Aircor Bundle Cone/Fillet Installation - Section

PROMASEAL® – HPE Sealant

Fire Resistant Plasterboard - 2 hour

2x13mm fire rated plasterboard on both sides of minimum 64mm steel stud

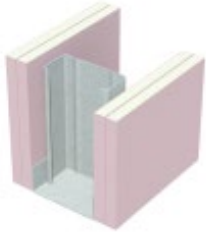

Assessment 250411 Table 23,24,45 & 46

SERVICE	MAXIMUM APERTURE SIZE (mm)	MAXIMUM ANNULAR GAP (mm)	METHOD		FRL
			Flush finish	Cone / Fillet finish	
16mm PEX/AL/PEX	36	10	✓	✓	-/180/180*
20mm PEX/AL/PEX	40	10	✓	✓	-/180/180*
25mm PEX/AL/PEX	45	10		✓	-/120/60
32mm PEX/AL/PEX	52	10		✓	-/120/90
16mm PEX	26	5 to 15	✓	✓	-/120/120
20mm PEX	30	5 to 15	✓	✓	-/120/120
25mm PEX	35	5 to 15		✓	-/120/120
Up to 19 x CAT 6 / Data cables	50	10		✓	-/180/180*
Up to 21 x 1.5mm Alarm/Fire cables	50	10		✓	-/120/120
Pair Coil Bundle (cable + PVC drain)	121	Min 10		✓	-/120/120
2x 20mm conduit with TPS & CAT 6	60	Min 10		✓	-/180/180*
Up to 23 x NBN / Fibre Optics Cables	60	10		✓	-/120/120
Up to 10 x NBN / Fibre Optics Cables	50	10		✓	-/180/180*

- * FRL -/180/180 only achieved where the double layer plasterboard/masonry wall has an established FRL of -/180/180.
- > Can be applied into timber framed walls provided the aperture is located at least 100mm from the stud.
- > Can be applied to concrete/masonry wall with a minimum thickness of 116mm
- > If number of cables in a bundle is decreased then annular gap size must be maintained by reducing aperture size
- > Services can be installed off centre of the aperture provided the annular gap is maintained and maximum aperture size not exceeded
- > Services can be installed at an angle, provided annular gap and aperture size are maintained.

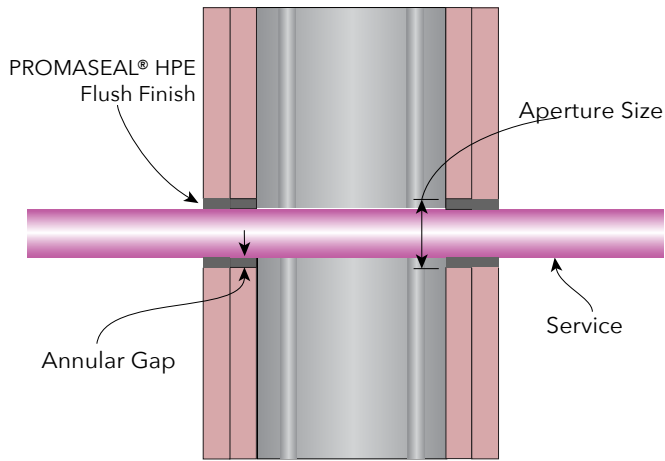

Pipe Flush Installation - Section

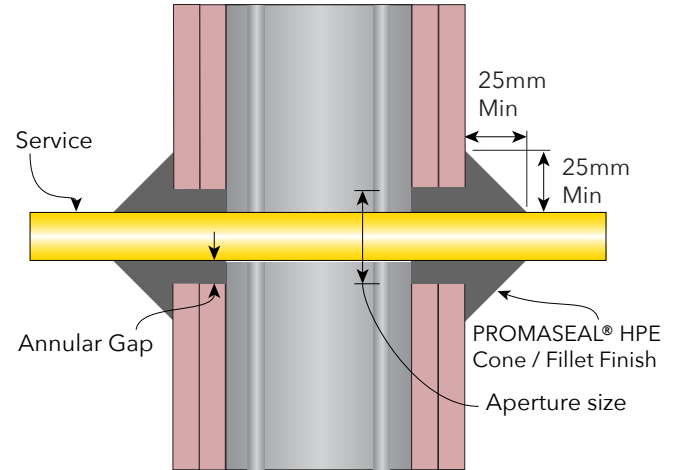

Pipe Cone/Fillet Installation - Section

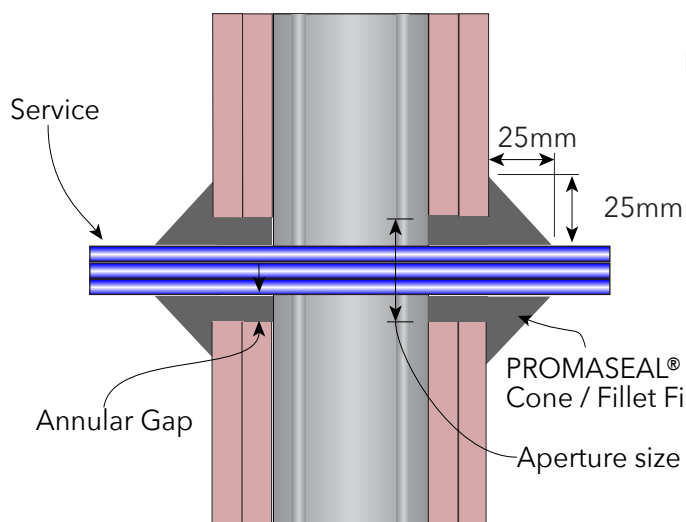

Cable Cone/Fillet Installation - Section

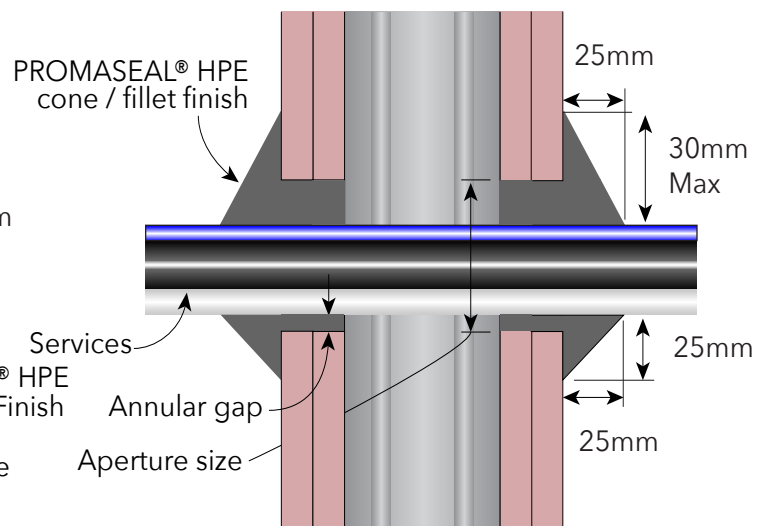

Aircon Bundle Cone/Fillet Installation - Section

PROMASEAL® – HPE Sealant

AAC / Hebel Panels
Min 75mm Thick



Assessment 250411
Tables 19, 20, 41 & 42

SERVICE	MAXIMUM APERTURE SIZE (mm)	MAXIMUM ANNULAR GAP (mm)	METHOD		FRL
			Flush finish	Cone / Fillet finish	
16mm PEX/AL/PEX	27	5	✓	✓	-/120/120
20mm PEX/AL/PEX	30	5		✓	-/120/120
25mm PEX/AL/PEX	35	5		✓	-/60/60
32mm PEX/AL/PEX	42	5	✓	✓	-/60/60
16mm PEX	27	5	✓	✓	-/120/120
20mm PEX	30	5	✓	✓	-/90/90*
25mm PEX	35	5	✓	✓	-/90/90*
Up to 19 x CAT 6 / Data cables	50	10		✓	-/120/120
Pair Coil Bundle (cable + PVC drain)	121	Min 10		✓	-/90/90
Up to 2x 20mm conduit with TPS & CAT 6	60	Min 10		✓	-/90/90
Up to 30 x 2.5mm TPS / Electrical Cables	80	10		✓	-/90/90
Up to 23 x NBN / Fibre Optics Cables	60	10		✓	-/120/120
Up to 10 x NBN / Fibre Optics Cables	50	10		✓	-/120/120

- * FRL of -/120/120 can be achieved using fillet/cone install
- > If number of cables in a bundle is decreased then annular gap size must be maintained by reducing aperture size
- > Services can be installed off centre of the aperture provided the annular gap is maintained and maximum aperture size not exceeded
- > Services can be installed at an angle, provided annular gap and aperture size are maintained.

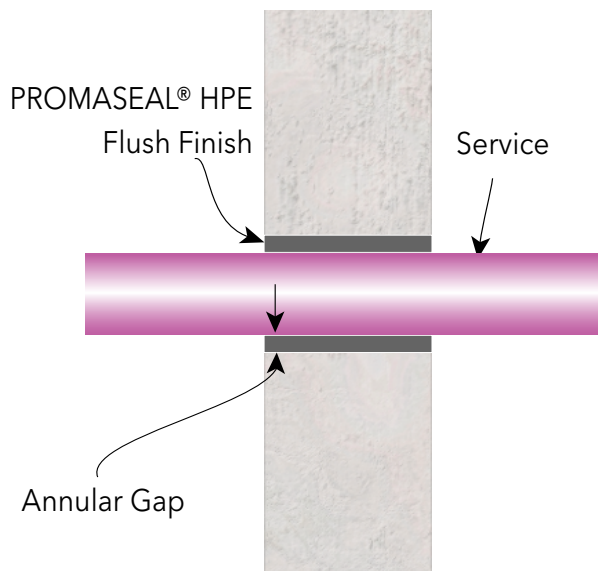

Pipe Flush Installation - Section

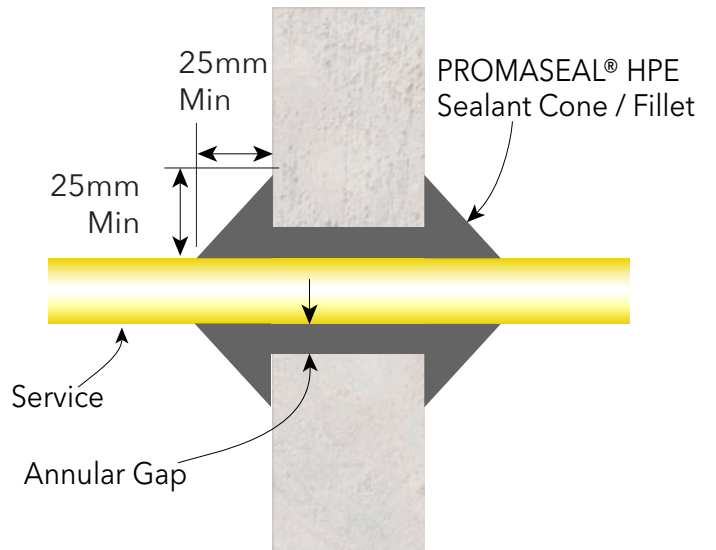

Pipe Cone/Fillet Installation - Section

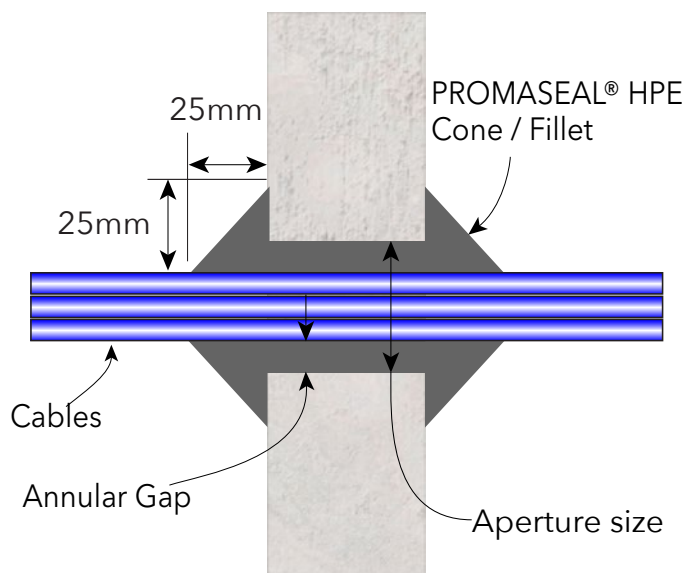

Cable Cone/Fillet Installation - Section

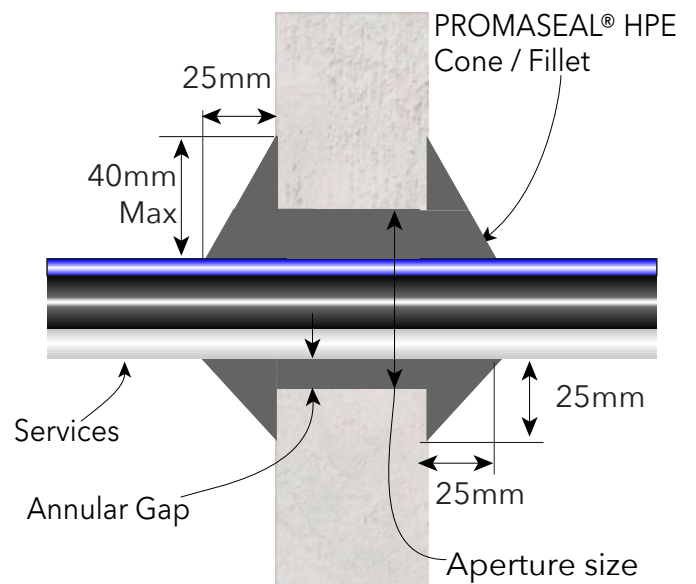

Aircon Bundle Cone/Fillet Installation - Section

PROMASEAL® – HPE Sealant

Speedpanel
Min 78mm Thick



Assessment 250411
Tables 21, 22, 43 & 44

SERVICE	MAXIMUM APERTURE SIZE (mm)	MAXIMUM ANNULAR GAP (mm)	METHOD		FRL
			Flush finish	Cone / Fillet finish	
16mm PEX/AL/PEX	26	5	✓	✓	-/120/120
16mm PEX	26	5	✓	✓	-/120/120
20mm PEX	30	5	✓		-/120/120
25mm PEX	35	5		✓	-/120/120
Up to 19 x CAT 6 / Data cables	50	10		✓	-/120/120
Up to 21 x 1.5mm Fire / Alarm Cables	50	10		✓	-/120/120
Up to 2x 20mm conduit with TPS & CAT 6	60	Min 10		✓	-/120/120
Up to 23 x NBN / Fibre Optics Cables	60	10		✓	-/120/120
Up to 10 x NBN / Fibre Optics Cables	50	10		✓	-/120/120

- > If number of cables in a bundle is decreased then annular gap size must be maintained by reducing aperture size
- > Services can be installed off centre of the aperture provided the annular gap is maintained and maximum aperture size not exceeded
- > Services can be installed at an angle, provided annular gap and aperture size are maintained.

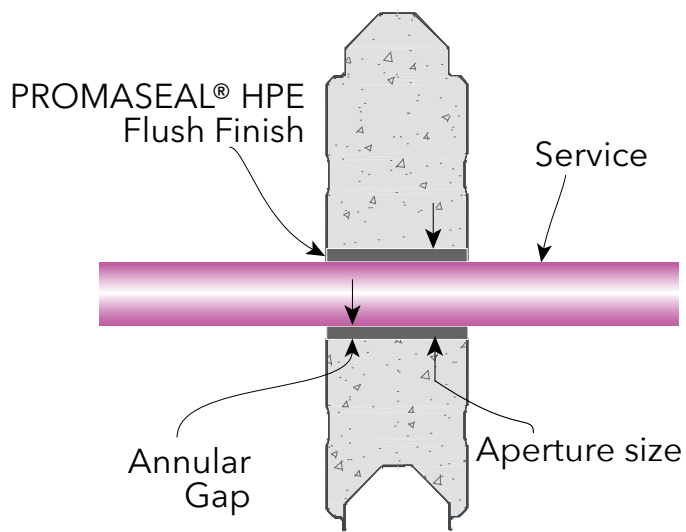

Pipe Flush Installation - Section

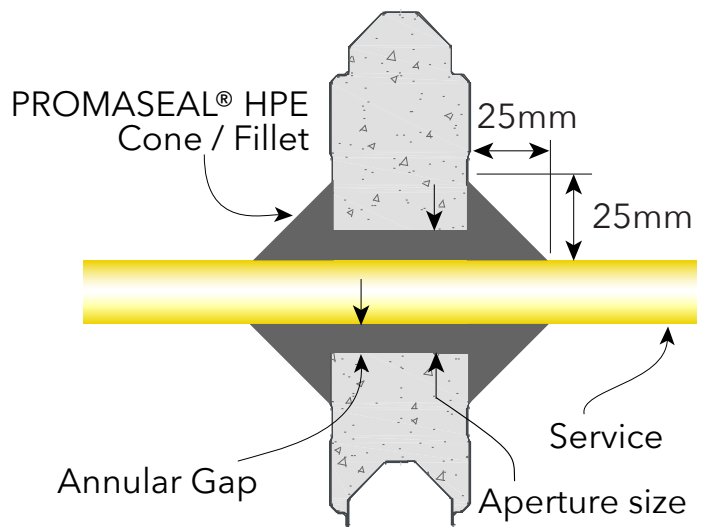

Pipe Cone/Fillet Installation - Section

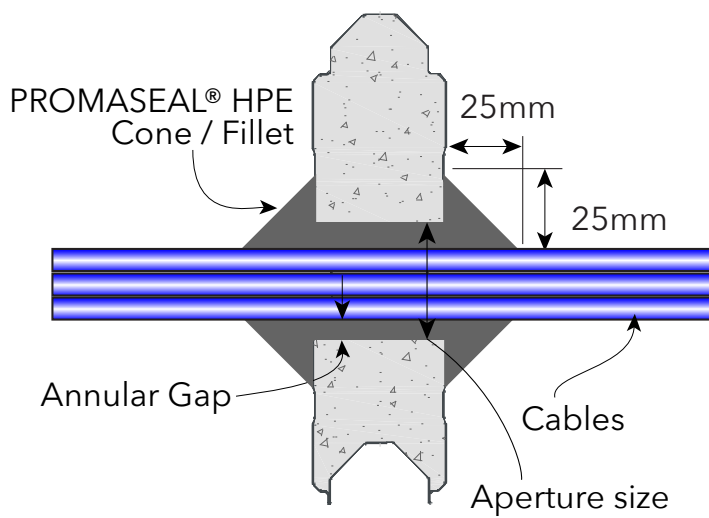

Cable Cone/Fillet Installation - Section

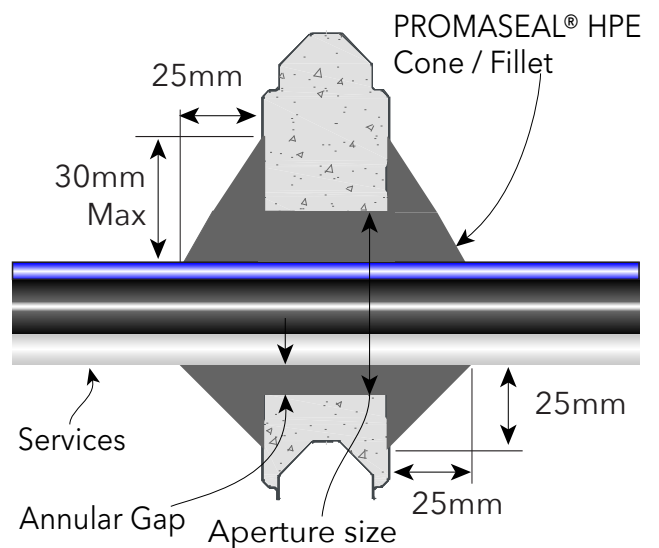

Aircon Bundle Cone/Fillet Installation - Section

PROMASEAL® – HPE Sealant

PROMASEAL® Bulkhead Batt

in approved wall type



Assesment 250411 Tables 25, 47, 48 & 49

SERVICE	MAXIMUM APERTURE SIZE (mm)	MAXIMUM ANNULAR GAP (mm)	METHOD		FRL
			Flush finish	Cone / Fillet finish	
16mm PEX/AL/PEX	36	10	✓		-/120/120
16mm PEX	36	10	✓		-/120/120
20mm PEX	40	10	✓		-/120/120
25mm PEX	45	10	✓		-/120/120
Up to 19 x CAT 6 / Data cables	50	10		✓	-/180/180
Up to 21 x 1.5mm Alarm/Fire cables	50	10		✓	-/180/180
Pair Coil Bundle (cable + PVC drain)	120	Min 10		✓	-/120/120
Up to 2 x 20mm conduit with TPS & CAT 6	60	Min 10		✓	-/120/120
Up to 23 x NBN / Fibre Optics Cables	60	10		✓	-/180/180
Up to 10 x NBN in Conduit (200mm Long)	50	10		✓	-/180/180
Bundle of 4 PEX Pipes	83	13-23.5mm		✓	-/180/180

- > FRL of Service limited to FRL of separating element
- > Install method and approved substrates for the PROMASEAL® Bulkhead Batts in accordance with FAS190202
- > If number of cables in a bundle is decreased then annular gap size must be maintained by reducing aperture size
- > Services can be installed off centre of the aperture provided the annular gap is maintained and maximum aperture size not exceeded
- > Services can be installed at an angle, provided annular gap and aperture size are maintained.
- > PEX bundle can include up to four pipes in any combination of sizes, provided that the annular gap is maintained

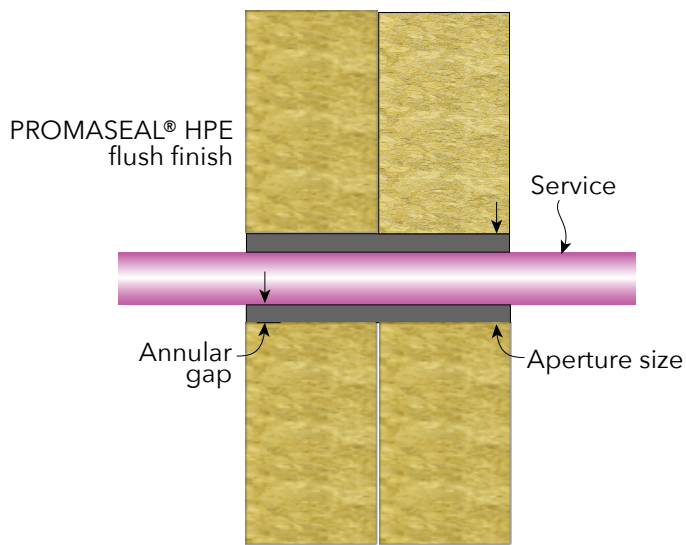

Pipe Flush Installation - Section

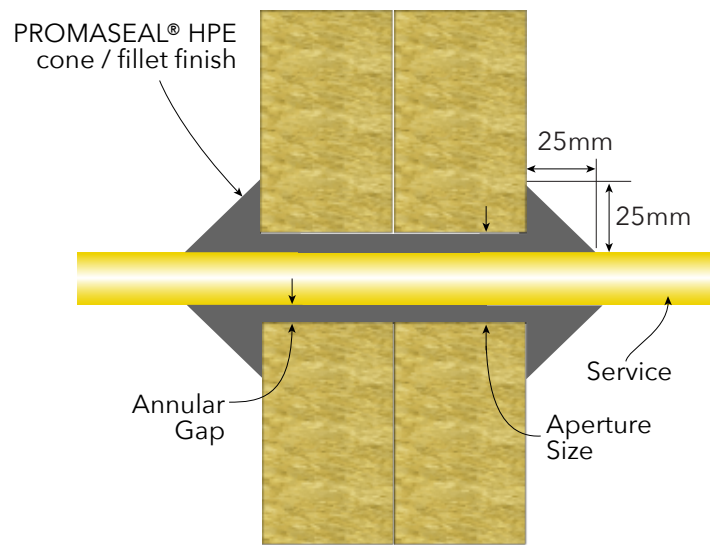

Pipe Cone/Fillet Installation - Section

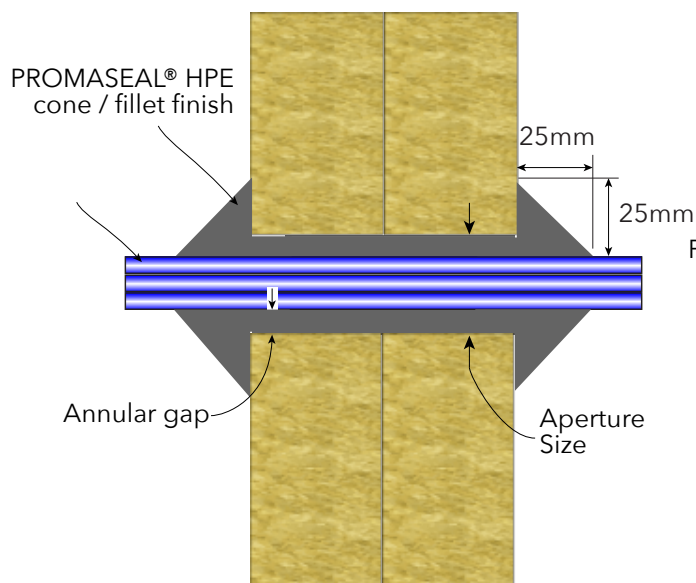

Cable Cone/Fillet Installation - Section

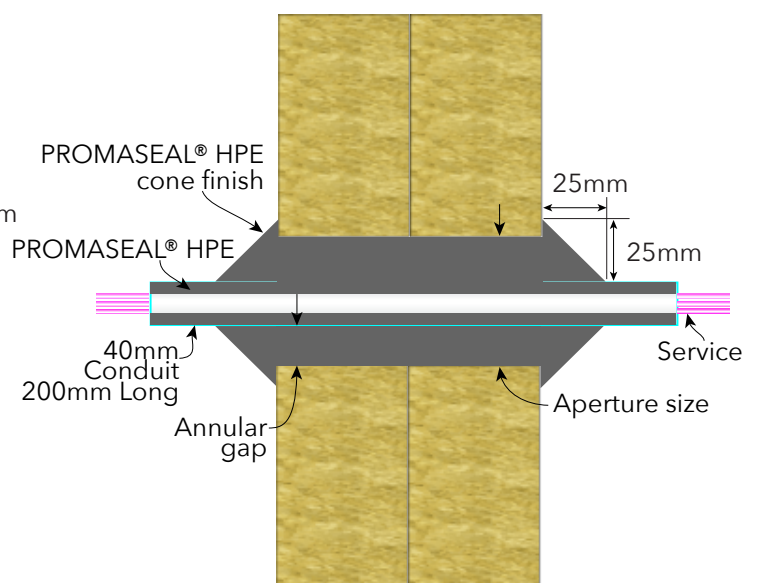

NBN Conduit
Cone/Fillet Installation - Section

PROMASEAL® – HPE Sealant

PROMASIL® 1100 Super

In minimum 116mm thick Fire Resistant Plasterboard Wall (2x13mm + 64mm stud)



Assessment 250411

Tables 26, 27, 28, 50, 51 & 52

SERVICE	MAXIMUM APERTURE SIZE (mm)	MAXIMUM ANNULAR GAP (mm)	METHOD		FRL
			Flush Finish +300mm SupaWrap	Cone / Fillet	
16mm PEX/AL/PEX	36	10	✓		-/120/120*
20mm PEX/AL/PEX	40	10	✓		-/120/120
25mm PEX/AL/PEX	45	10	✓		-/90/90
32mm PEX/AL/PEX	52	10	✓		-/90/90
Bundle of 4 PEX/AL/PEX	83	10	✓		-/60/60
16mm PEX	36	10		✓	-/120/120
20mm PEX	40	10		✓	-/120/120
25mm PEX	45	10		✓	-/120/120
Bundle of 4 PEX	83	10	✓		-/60/60
Up to 19 x CAT6 Cables	50	10		✓	-/60/60
Up to 30 x TPS Cables	80	10	✓		-/90/90
Up to 2 x 20mm Conduit with TPS & CAT6	60	10		✓	-/120/120
Up to 23 x NBN / Fibre Optic Cables	60	10		✓	-/120/120
UP to 10 x NBN in Conduit (160mm long)	50	5		✓	-/120/120
Pair Coil Bundle (+ Cable & Drain)	120	10	✓		-/90/90

- * FRL of -/180/180 can be achieved with PROMASIL® board installed in a -/180/180 separating barrier
- > If number of cables in a bundle is decreased then annular gap size must be maintained by reducing aperture size
- > Services can be installed off centre of the aperture provided the annular gap is maintained and maximum aperture size not exceeded
- > Services can be installed at an angle, provided annular gap and aperture size are maintained.
- > PROMASIL® board can be installed in alternate separating elements if approved

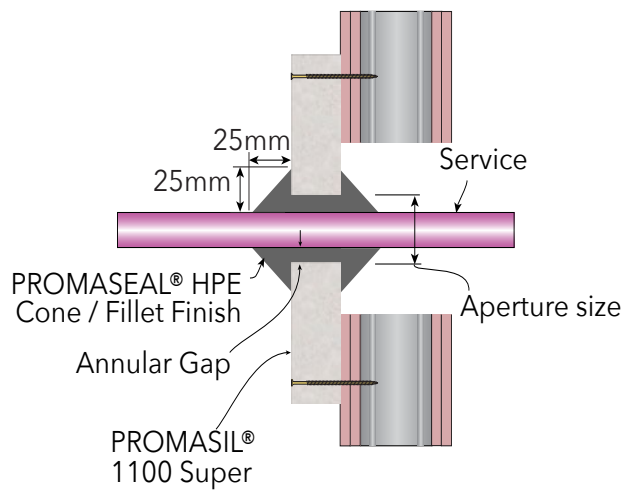

Pipe Cone Installation

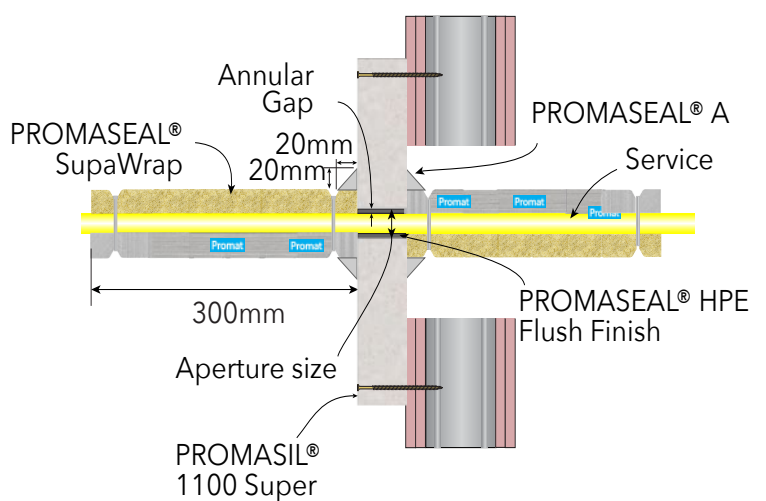

Pipe + Wrap Installation - Section

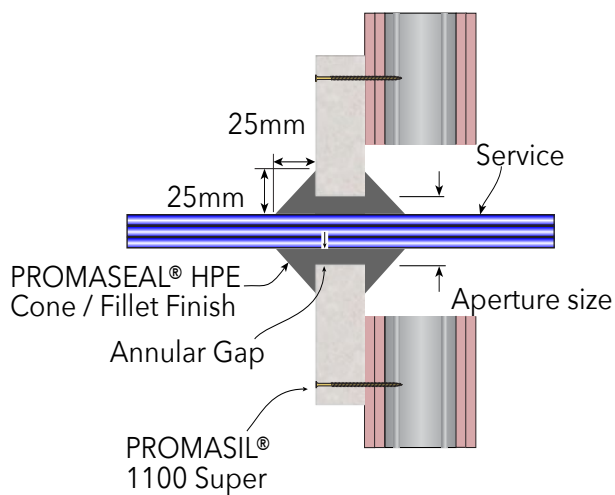

Cable Cone Installation - Section

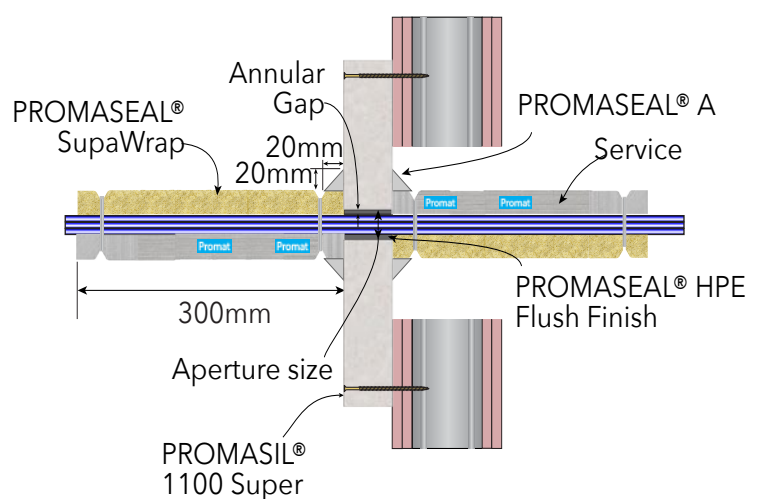

Cable + Wrap Installation - Section

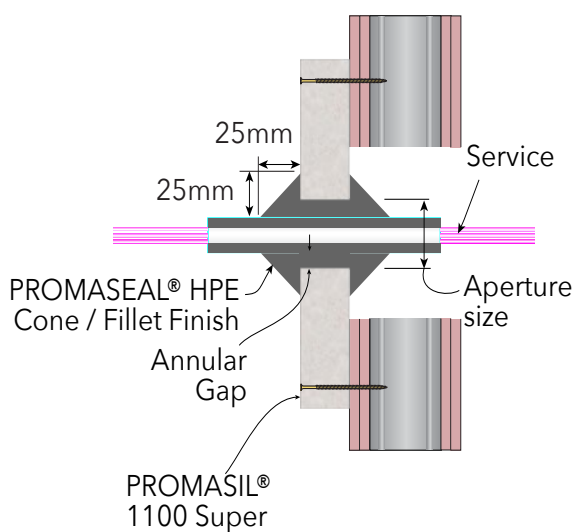

Conduit + Cone Installation - Section

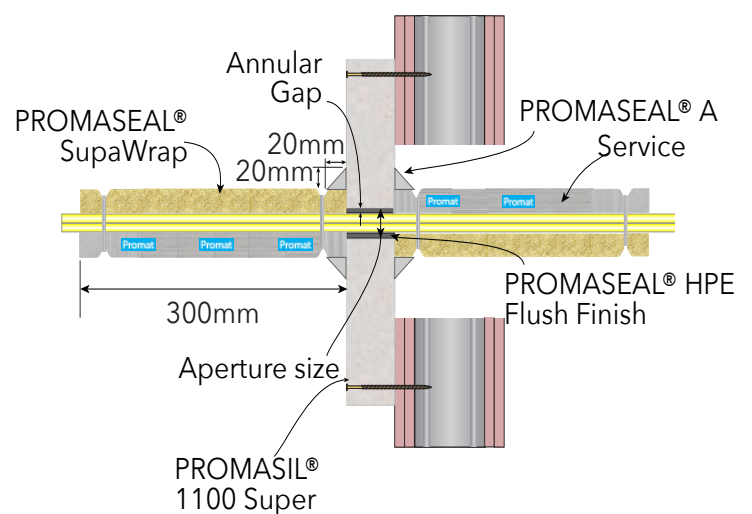

Pipe Bundle + Wrap Installation - Section

PROMASEAL® – HPE Sealant

Concrete Slabs
Minimum 120mm thick



Assessment 250411
Tables 29, 30, 53,54 & 55

SERVICE	MAXIMUM APERTURE SIZE (mm)	MAXIMUM ANNULAR GAP (mm)	METHOD			FRL
			Flush finish	Cone / Fillet finish	Cone / Fillet +300mm SupaWrap	
16mm PEX/AL/PEX	38	11		✓	✓	-/120/120
20mm PEX/AL/PEX	38	9			✓	-/120/120
25mm PEX/AL/PEX	50	12		✓		-/120/120
16mm PEX	38	11	✓	✓		-/120/120*
20mm PEX	38	9	✓	✓		-/120/120*
25mm PEX	50	12	✓	✓		-/120/120*
Bundle of 4 Pex Pipes (16,20,25,32)	83	10		✓	✓	-/120/120
Up to 19 x CAT 6 / Data cables	50	10		✓		-/120/120
Up to 21 x 1.5mm Alarm/Fire Cables	50	10		✓		-/120/120
Aircon Bundle (inc Cable + uPVC drain)	114	Min 10		✓		-/120/120
2x 20mm conduit with TPS & CAT 6	64	Min 10		✓		-/120/120
Up to 30 x 2.5mm TPS / Electrical Cables	83	10		✓		-/120/120
Up to 23 x NBN / Fibre Optics Cables	64	10		✓		-/120/120
Up to 10 x NBN in Conduit (220mm long)	50	5		✓		-/120/120

- * FRL of -/180/180 can be achieved with cone/fillet install in a -/180/180 concrete slab
- > If number of cables in a bundle is decreased then annular gap size must be maintained by reducing aperture size
- > Service combination for the Aircon bundle can be changed to remove any item provided the annular gap is maintained
- > Services can be installed off centre of the aperture provided the annular gap is maintained and maximum aperture size not exceeded
- > Services can be installed at an angle, provided annular gap and aperture size are maintained.
- > PEX bundle can include up to 4 pipes in any combination of sizes, provided that the annular gap is maintained

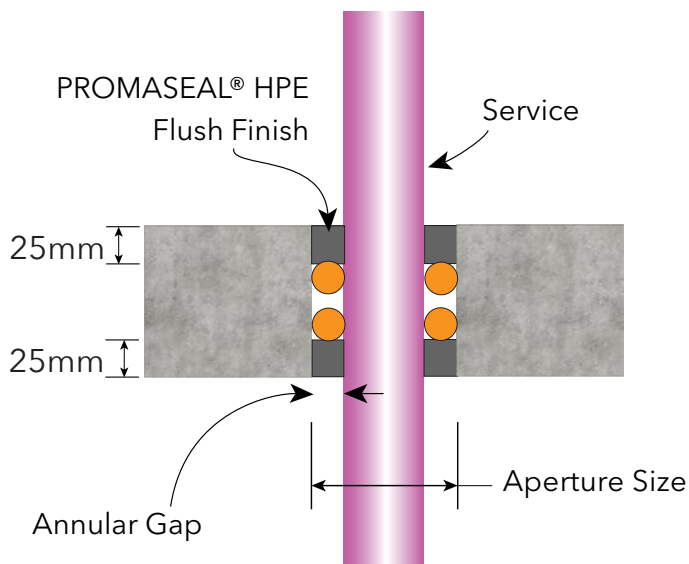

Pipe Flush Installation - Section

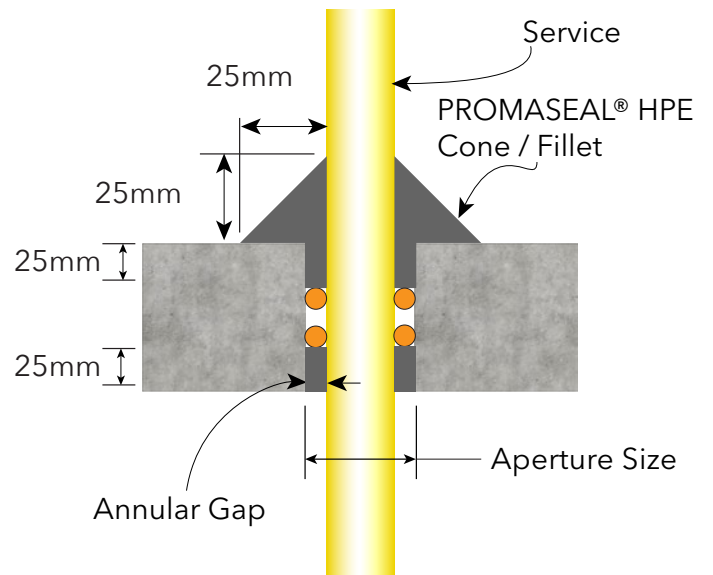

Pipe Cone/Fillet Installation - Section

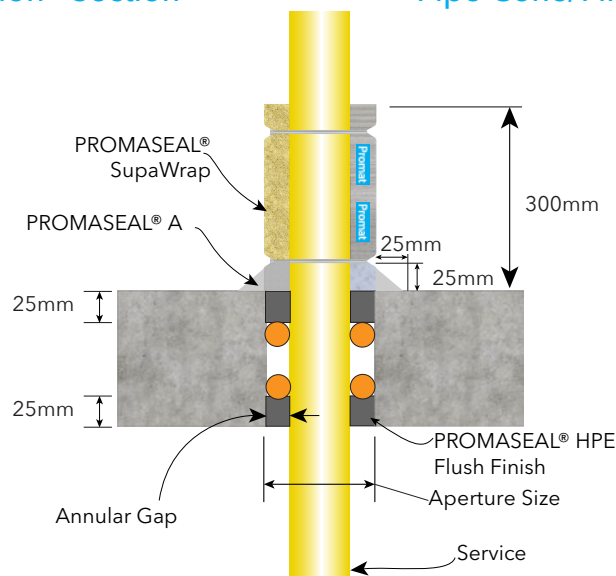

Pipe Flush + Wrap Installation - Section

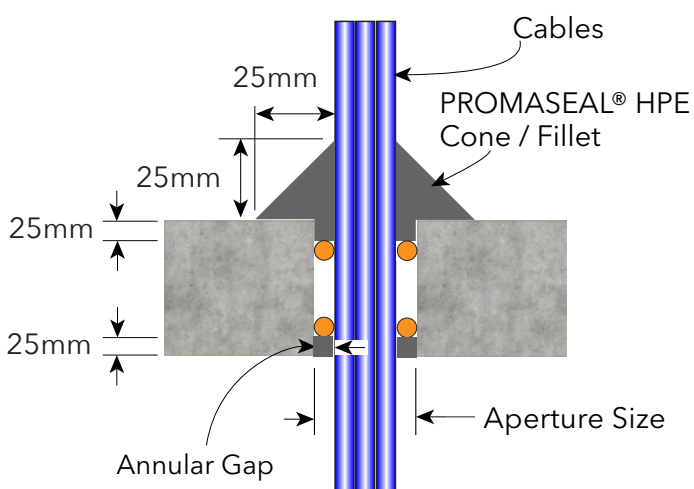

Cable Cone/Fillet Installation - Section

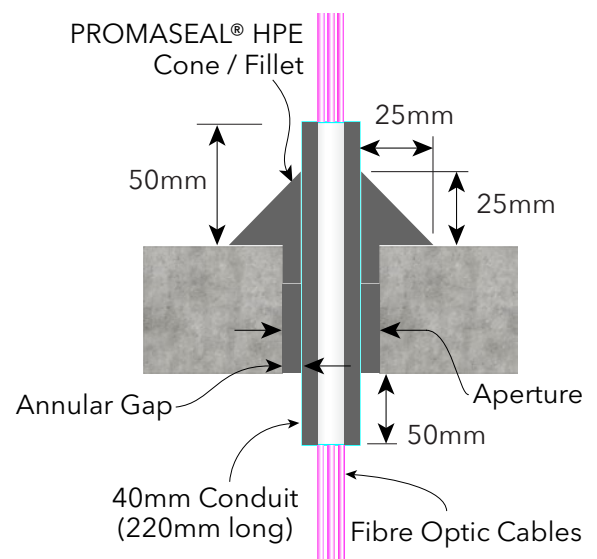

NBN Conduit Cone/Fillet Installation - Section

PROMASEAL® – HPE Sealant

PROMASEAL® Bulkhead Batt

in Minimum 120mm thick concrete slab

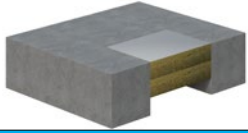

Assesment 250411 Tables 31-34 & 56-58

SERVICE	MAXIMUM APERTURE SIZE (mm)	MAXIMUM ANNULAR GAP (mm)	METHOD			FRL
			Flush finish	Cone / Fillet finish	Cone / Fillet +300mm SupaWrap	
16mm PEX/AL/PEX	36	10		✓		-/120/120
20mm PEX/AL/PEX	40	10		✓		-/120/120
32mm PEX/AL/PEX	52	10			✓	-/120/120
16mm PEX	36	10	✓			-/120/120
20mm PEX	40	10	✓			-/120/120
25mm PEX	45	10	✓			-/120/120
Up to 19 x CAT 6 / Data cables	50	10		✓		-/120/120
Up to 21 x 1.5mm Alarm/Fire Cables	50	10		✓		-/120/120
Pair Coil Bundle (inc Cable + uPVC drain)	120	Min 10		✓		-/120/120
2x 20mm conduit with TPS & CAT 6	60	Min 10		✓		-/120/120
Up to 23 x NBN / Fibre Optics Cables	64	10		✓		-/120/120
Up to 10 x NBN in Conduit (220mm long)	50	5		✓		-/120/120

- > Install method and approved substrates for the PROMASEAL® Bulkhead Batts in accordance with FAS190202
- > If number of cables in a bundle decreases then annular gap size must be maintained by reducing aperture size
- > Services can be installed off centre of the aperture provided the annular gap is maintained and maximum aperture size not exceeded
- > Services can be installed at an angle, provided annular gap and aperture size are maintained.

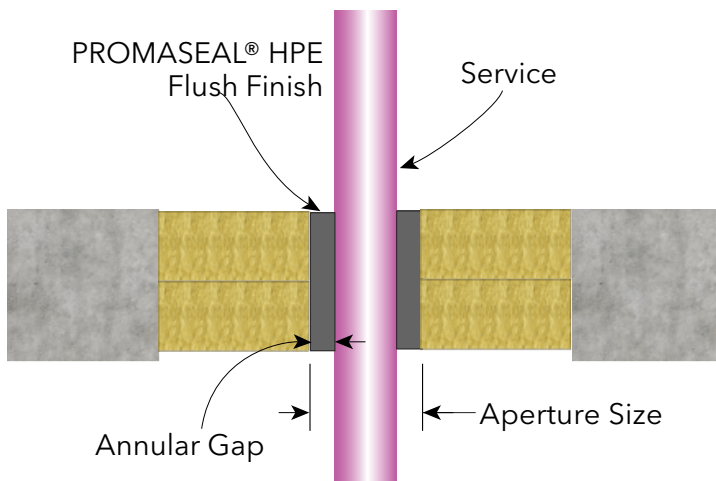

Pipe Cone Installation - Section

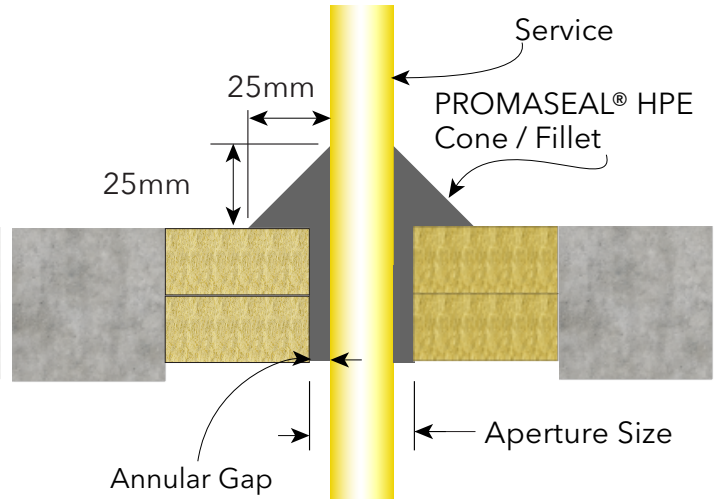

Pipe + Wrap Installation - Section

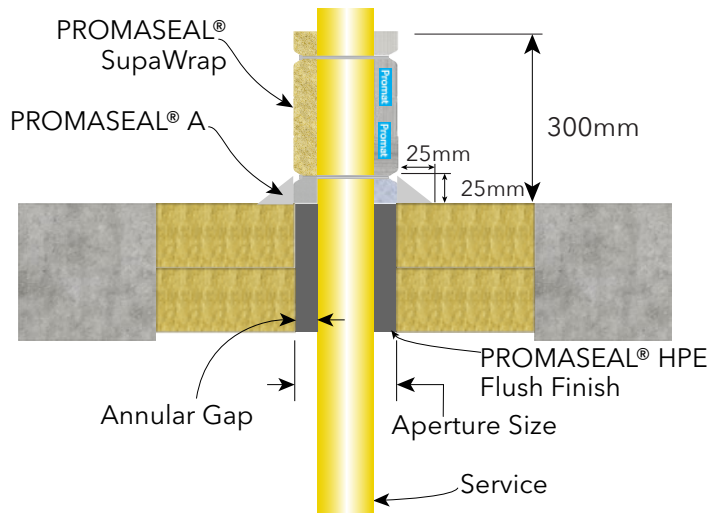

Cable Cone Installation - Section

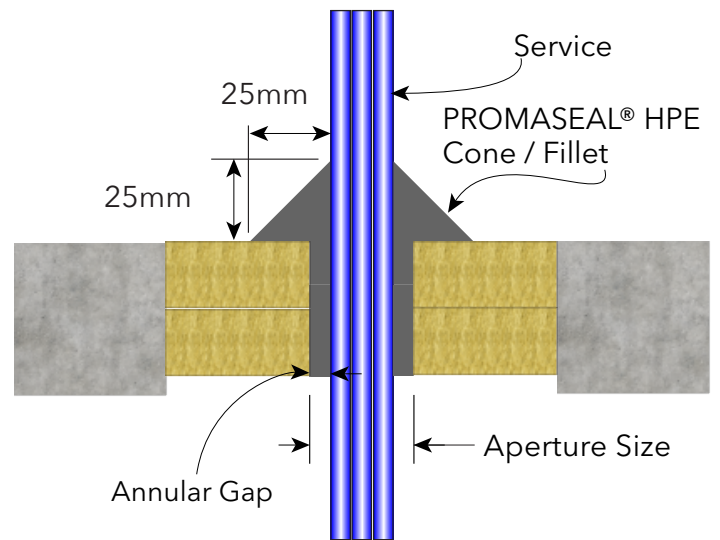

Cable + Wrap Installation - Section

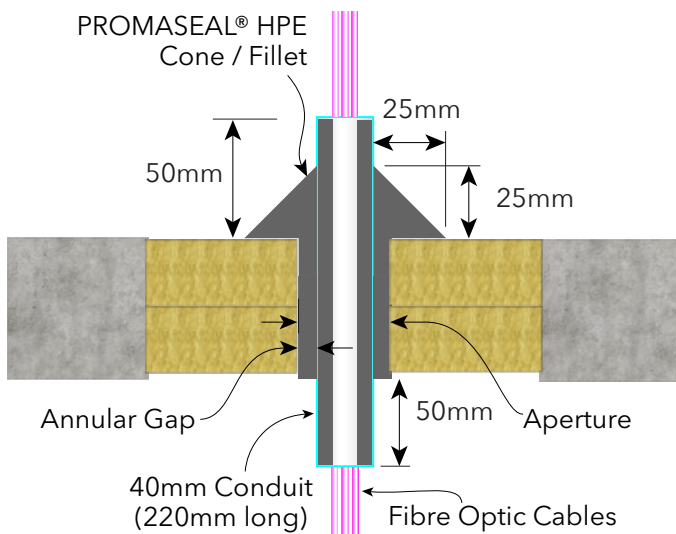

Conduit + Cone Installation - Section

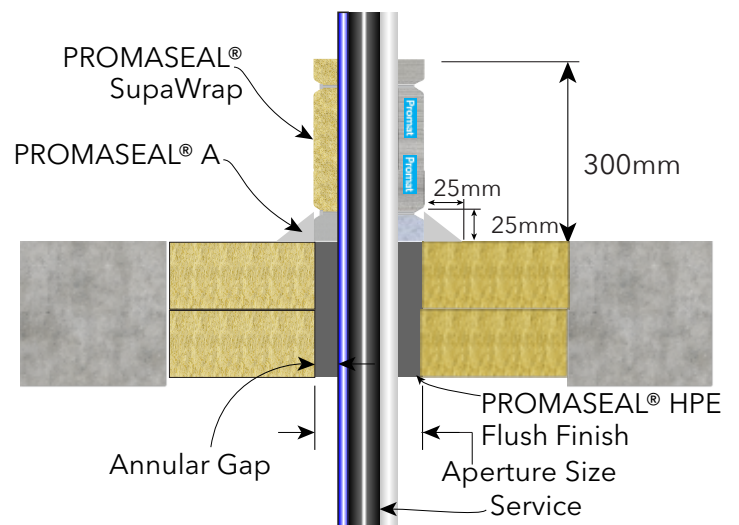

Aircon Bundle + Wrap Installation - Section

PROMASEAL® – HPE Sealant

PROMASIL® 1100 Super

In minimum 120mm thick concrete slab



Assesment 250411 Tables 35-38 & 59-63

SERVICE	MAXIMUM APERTURE SIZE (mm)	MAXIMUM ANNULAR GAP (mm)	METHOD			FRL
			Flush finish	Cone / Fillet finish	Cone / Fillet +300mm SupaWrap	
16mm PEX/AL/PEX	36	10		✓	✓	-/120/120*
20mm PEX/AL/PEX	40	10			✓	-/120/120*
20mm PEX/AL/PEX	40	10		✓		-/90/90
25mm PEX/AL/PEX	45	10		✓	✓	-/120/120
32mm PEX/AL/PEX	52	10			✓	-/90/90
32mm PEX/AL/PEX	52	10		✓		-/60/60
16mm PEX	36	10	✓	✓		-/120/120*
20mm PEX	40	10	✓	✓		-/120/120
25mm PEX	45	10		✓		-/120/120
25mm PEX	45	10	✓			-/90/90
2 x 20mm Conduit with TPS & CAT6	60	10		✓		-/90/90
Up to 19 x CAT 6 / Data cables	50	10		✓		-/120/120
Up to 21 x Alarm / Fire Cables	50	10		✓		-/60/60
Up to 23 x NBN / Fibre Optic Cable	60	10		✓		-/120/120
Up to 10 x NBN in Conduit (160mm long)	50	5		✓		-/120/120
Aircon Bundle (+ Cable & Drain)	120	10			✓	-/90/90

* FRL -/180/180 can be achieved when PROMASIL Installed into slab with FRL -/180/180

- > PROMASIL® board can be installed in alternate locations if approved
- > If number of cables in a bundle is decreased then annular gap size must be maintained by reducing aperture size
- > Services can be installed off centre of the aperture provided the annular gap is maintained and maximum aperture size not exceeded
- > Services can be installed at an angle, provided annular gap and aperture size are maintained.

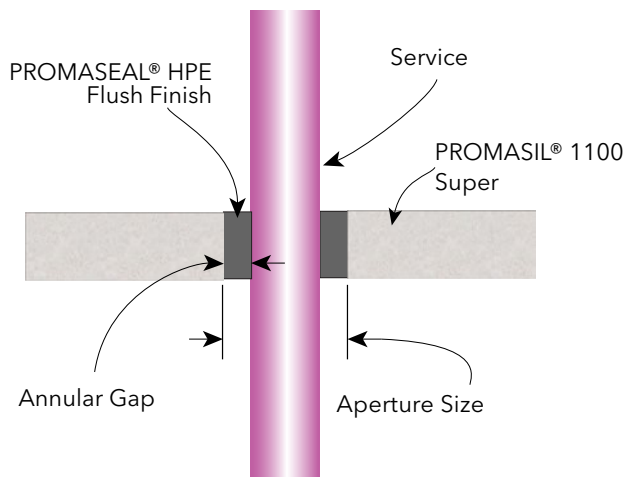

Pipe Flush Installation - Section

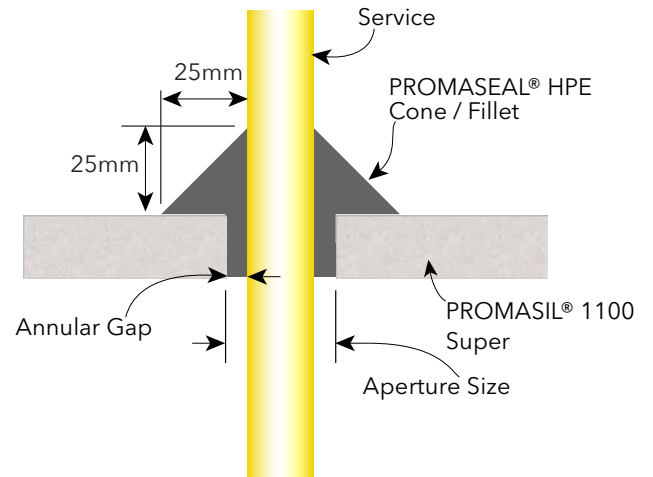

Pipe Cone Installation - Section

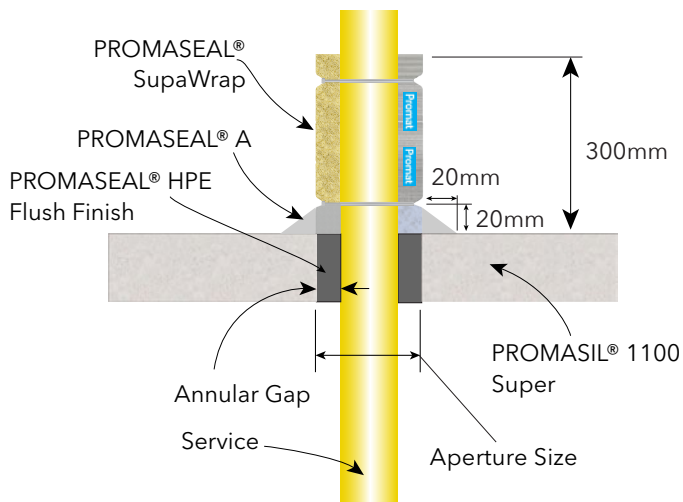

Pipe + Wrap Installation - Section

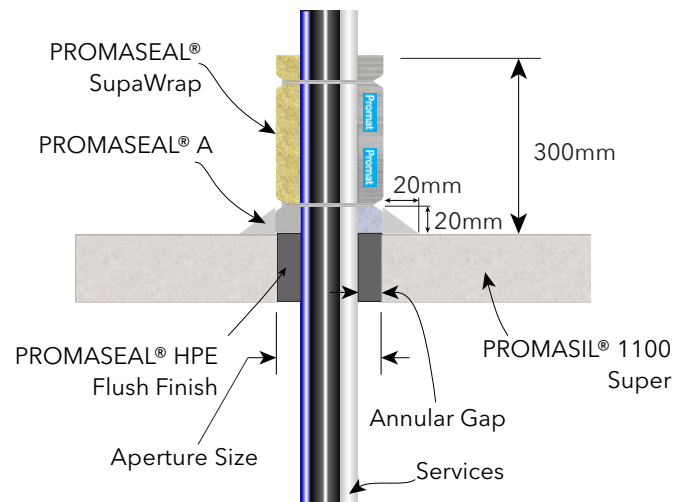

Aircon Bundle + Wrap Installation - Section

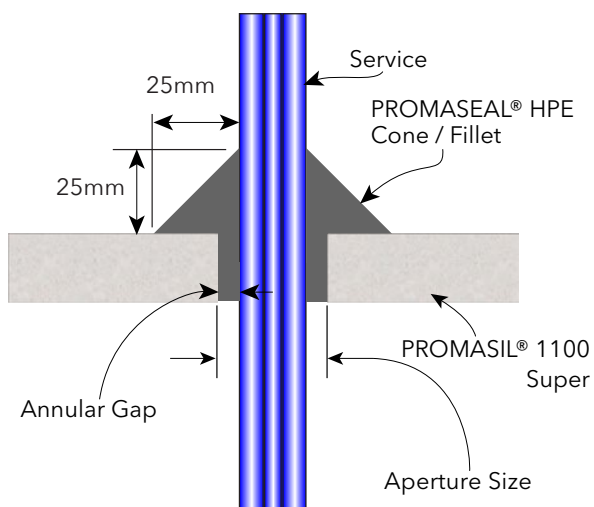

Cable Cone Installation - Section

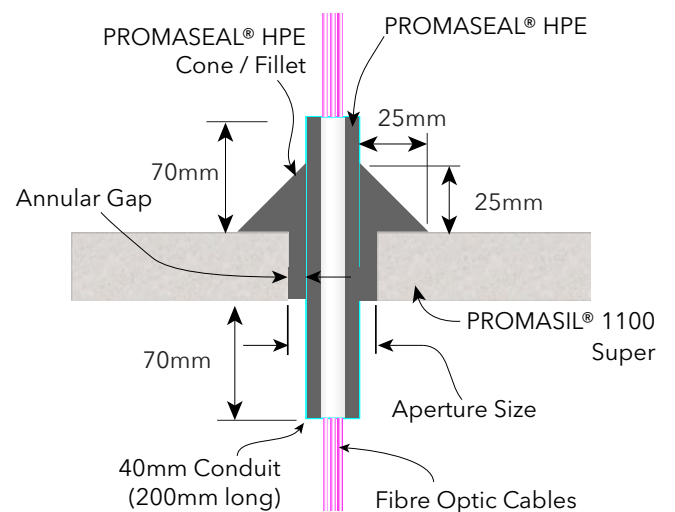

Conduit + Cone Installation - Section



by etex

Etex Australia

South Australia office

1 Scotland Road
SA 5031 Mile End South
☎ 1800 Promat (776 628)
☎ +61 8 8352 1014
✉ PAPL.mail@etexgroup.com

New South Wales office

Unit 1, 175 Briens Road
Northmead, NSW 2152
☎ 1800 Promat (776 628)
☎ +61 2 9630 0258
✉ PAPL.mail@etexgroup.com

Victoria office

10-20 Jordan Close
Altona, VIC 3018
☎ 1800 Promat (776 628)
☎ 1800 334 598
✉ PAPL.mail@etexgroup.com

Queensland office

80 Stradbroke St
Heathwood QLD 4110
☎ 1800 011 376
☎ 1800 334 598
✉ PAPL.mail@etexgroup.com

promat.com



Promat Fire Stopping
Selector App



PROMASEAL® HPE
Product Information