

## INVISACOUSTICS: Under Slab Ceiling Panels

**DO NOT REMOVE INVISACOUSTICS CEILING PANELS FROM THE CARTON UNTIL YOU HAVE READ THESE INSTRUCTIONS IN THEIR ENTIRETY.**

### 1. GENERAL

#### 1.1 Product Description

INVISACOUSTICS Ceiling Panels referenced in these instructions are made from an Armstrong OPTRA Glasswool substrate. The panels are installed in one direction, as illustrated below and can be demounted from the opposite direction. INVISACOUSTICS Panels are designed to be attached to an aluminium Mounting Grid System, which is direct mounted, typically to a concrete soffit. All panels can be removed and re-installed without tools or special equipment. INVISACOUSTICS Panels are available in one standard size: 1200x600mm (Nom) and are standard in 20mm thickness (30mm thickness available on request).

#### 1.2 Surface Finish

The face of the INVISACOUSTICS Ceiling Panels feature a painted durable, acoustically transparent scrim on the face and veil on the back surface. The beveled K4C4 edges are paint sealed, with colour to match the face.

#### 1.3 Storage and Handling

The ceiling panels shall be stored in a dry interior location and shall remain in cartons prior to installation to avoid damage. The cartons shall be stored in a flat position. Proper care should be taken when handling to avoid damage or soiling.

#### 1.4 Working With Glasswool and Mineral Fiber Products

##### 1.4.1 Precautionary Measures:

During the installation be certain that the work site is well ventilated and avoid breathing dust. If high dust levels are anticipated during installation such as with the use of power tools, use appropriate NIOSH designated dust respirator. All power cutting tools must be equipped with dust collectors. Avoid contact with skin or eyes. Wear long-sleeved, loose-fitting clothes, gloves and eye protection.

##### 1.4.2 First Aid Measures:

If contact occurs flush eyes and skin irritation with plenty of water for at least 15 minutes and remove contaminated clothing. After installing material, wash with warm water and mild soap. Wash work clothes separately from other clothing.

Rinse washer thoroughly. Refer to Armstrong MSDS (which includes information on established occupational exposure limits) which are available from Armstrong or your employer.

#### 1.5 Site Conditions

Building areas to receive ceilings shall be free of construction dust and debris. These products are not recommended for exterior applications or where standing water is present or where moisture will come in direct contact with the ceiling.

#### 1.6 Storage and Handling

The Panels shall be stored in a dry interior location and shall remain in their original cartons prior to installation to avoid damage. The cartons shall be stored in a flat, horizontal position. The Panels should not be removed from the carton until the suspension system is installed. Proper care should be taken when handling to avoid damage and soiling. White cotton or latex gloves are recommended for handling.

#### 1.7 Temperature During Installation

Baffles can be installed where the temperature is between 4°C and 49°C. Baffles cannot be used in exterior applications, where standing water is present, or where moisture will come in direct contact with the Baffles.

#### 1.8 Plenum

Installation of the INVISACOUSTICS grid system is directly fixed to the structure, creating an open plenum design.

#### 1.9 Fire Sprinklers, Cables and Services

INVISACOUSTICS Panels are designed to be installed above or around major plenum services. Fire services, including sprinkler heads and smoke detectors should be mounted beneath the face of the panel to ensure there is no obstruction to their function. Please consult a fire protection engineer and the local codes for guidance where automatic fire detection and suppression systems are present. The INVISACOUSTICS System has a an air gap of 30mm between the back of the panel and the slab or structure.

#### 2.0 Before You Start

All material delivered to site should be checked for damage, unopened and original packages.

All materials to be kept dry and protected from the elements.

## 2. INSTALLATION

### 2.1 Suspension Systems

There are two grid components for the INVISACOUSTICS System as follows:

Item	Description	Dimension
INVMG	Mounting Grid	50 x 20 x 3600mm
INVHCA	Hanger Clip Assembly	27 x 150mm

### 2.2 General

INVISACOUSTICS Panels cannot be used to support any other material.

The suspension Grid System must be fastened to the structure in accordance with building code in your area.

Determine Grid and Panel Location and Direction.

INVISACOUSTICS Grid and Panels are to be Installed as per specification and drawings. The drawing supplied by the builder will show the orientation of the panel required.

## 3.0 GRID AND PANEL INSTALLATION

### STEP 1

**1.1** Fix Aluminium Mounting Grid at 600mm centres to slab or structure, with fixings at 1200mm centres. Mounting Grid is 3600mm in length and can be installed end to end without joiners.

**1.2** Install Wall Angle or Floating Perimeter Trim as required a maximum of 450mm from the end of the 1st row of Mounting Grid sections.

#### Perimeter Solutions

Item	Description	Dimensions
ALSW1	Heavy Duty Wall Angle	25 x 35 x 3600mm
CT20	"C" Perimeter Trim (20mm Panel)	25 x 45 x 3600mm
CT30	"C" Perimeter Trim (30mm Panel)	25 x 55 x 3600mm

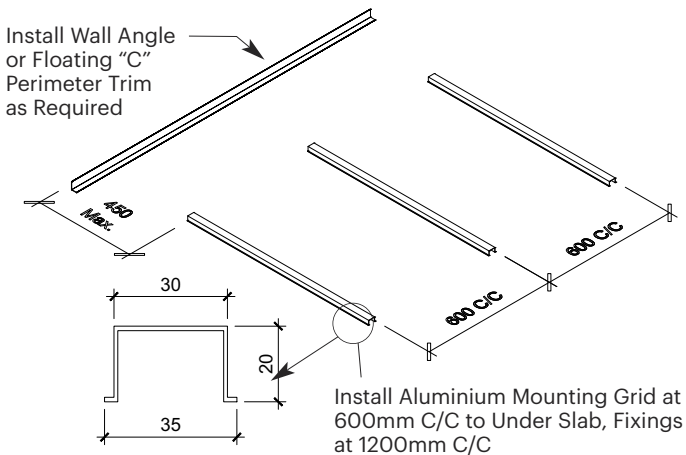

### STEP 2

Using a string line, position and install the first row of Hanger Assembly Clips as per the reflected ceiling plan. These are simply pushed up onto the Mounting Grid and fixed with an audible click.

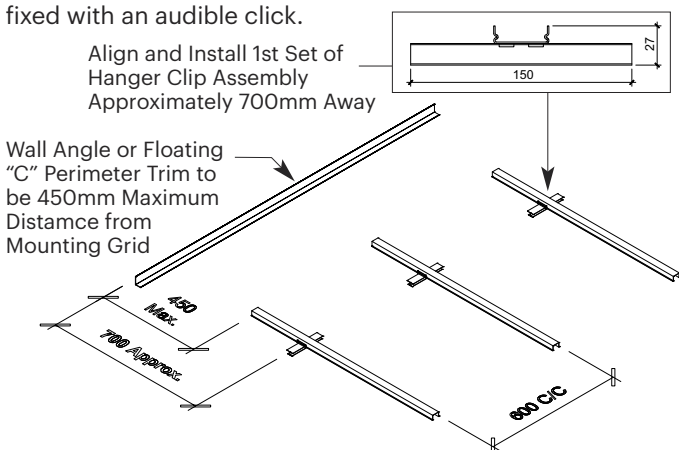

### STEP 3

1. Lift Panel and slide onto the Wall Angle or Floating "C" Perimeter Trim

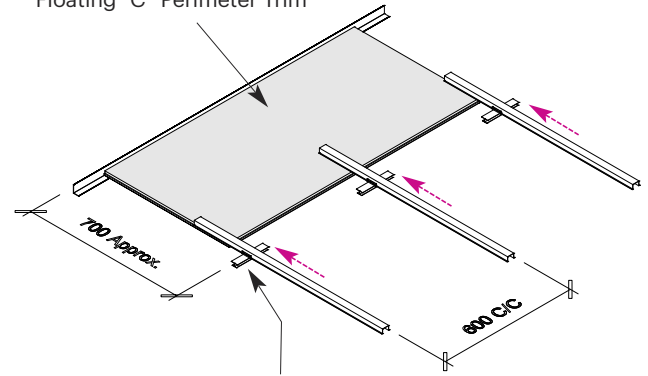

2. Slide Hanger Clip Assembly forward to Support Panel. The Panel's K4C4 edge will be fitted into three Hanger Clips along its 1200mm length.

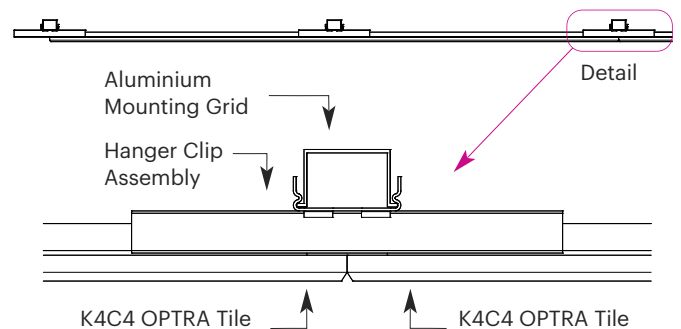

### STEP 4

Before the 2nd panel can be installed, slide the "I" Trim (section of the Hanger Clip Assembly) to one side, as per drawing below)

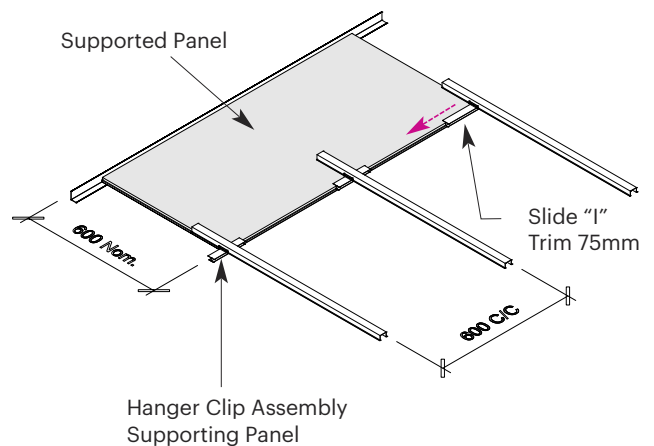

### STEP 5

Continue installing Mounting Grid and Hanger Clip Assemblies as shown according to the reflected ceiling plan.

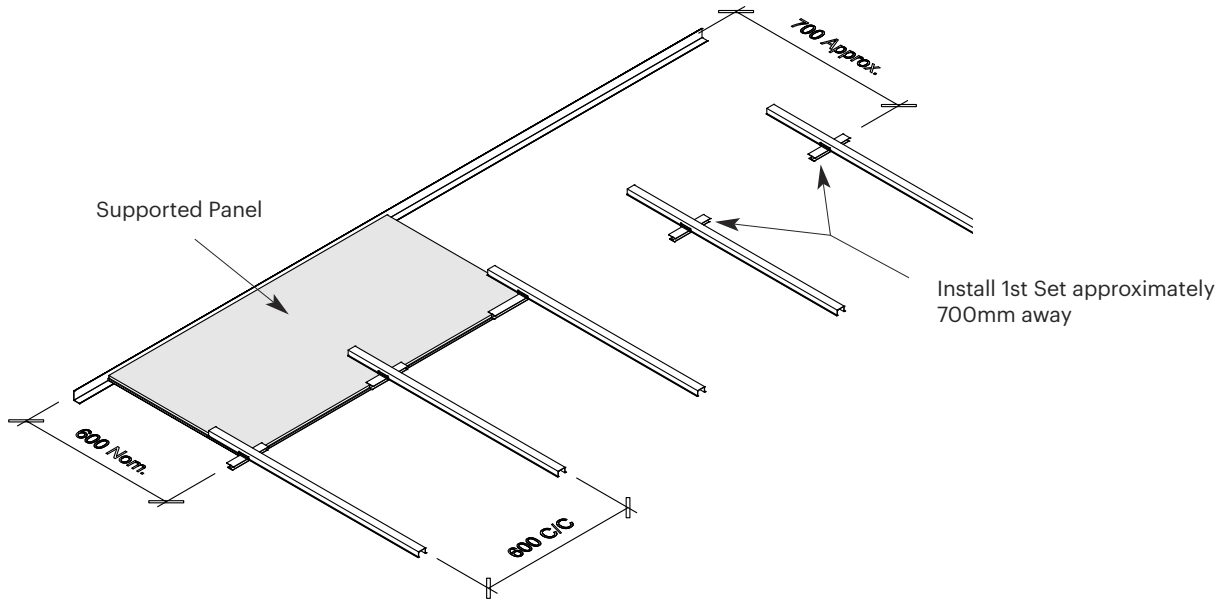

### STEP 6

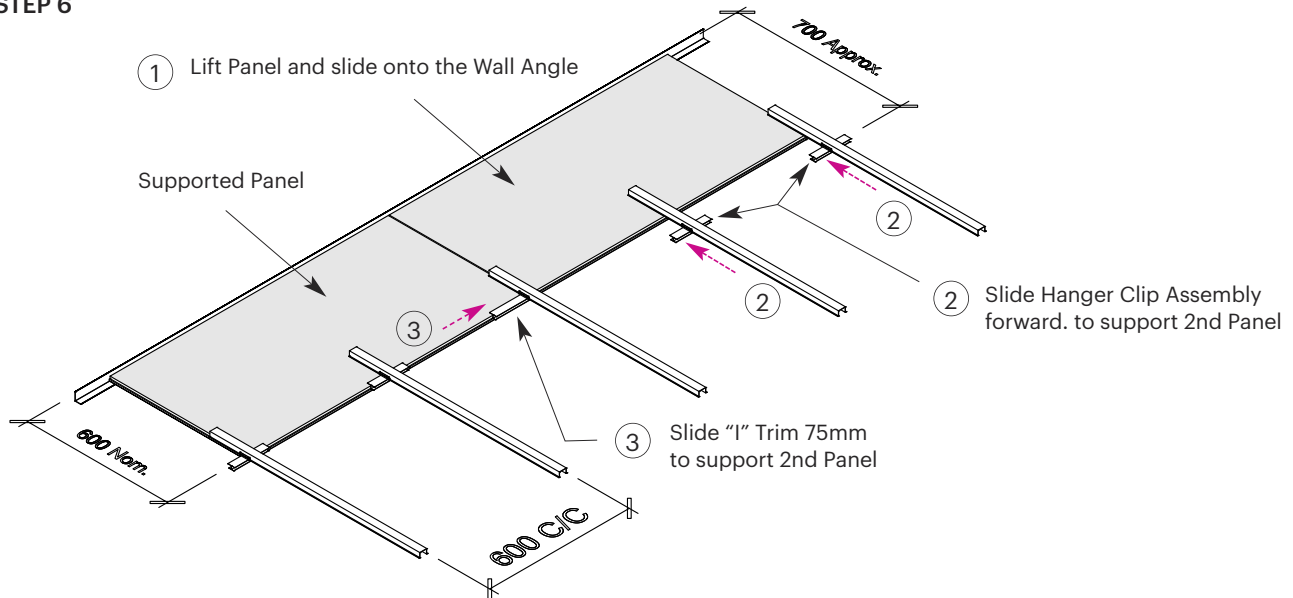

### STEP 7

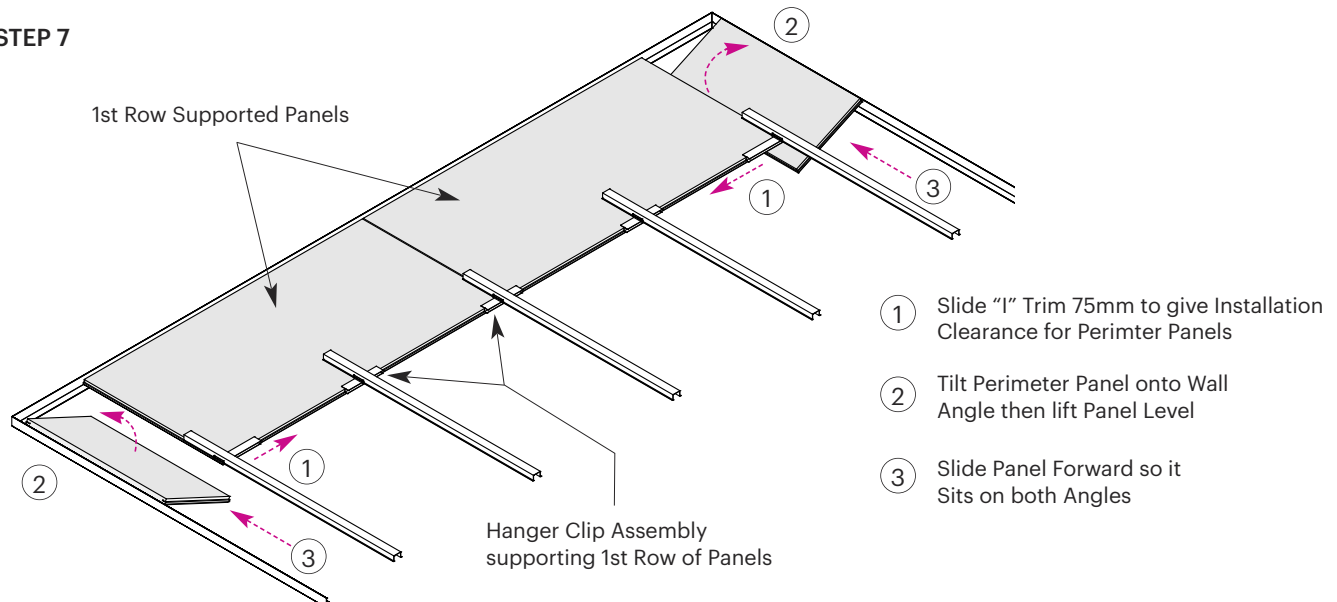

**STEP 8**

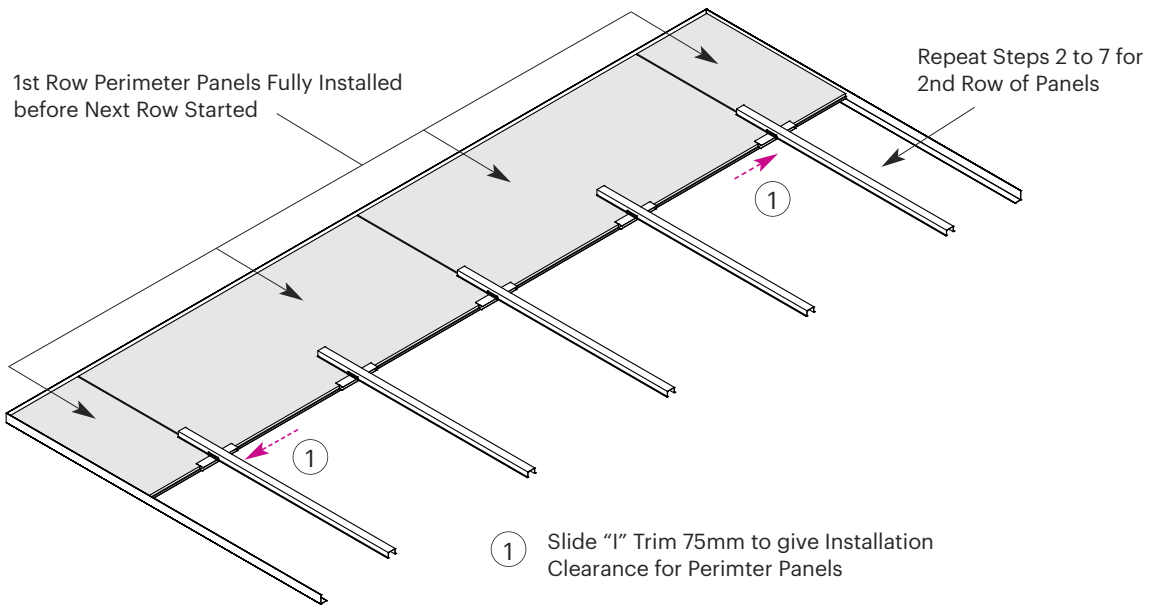

**STEP 9**

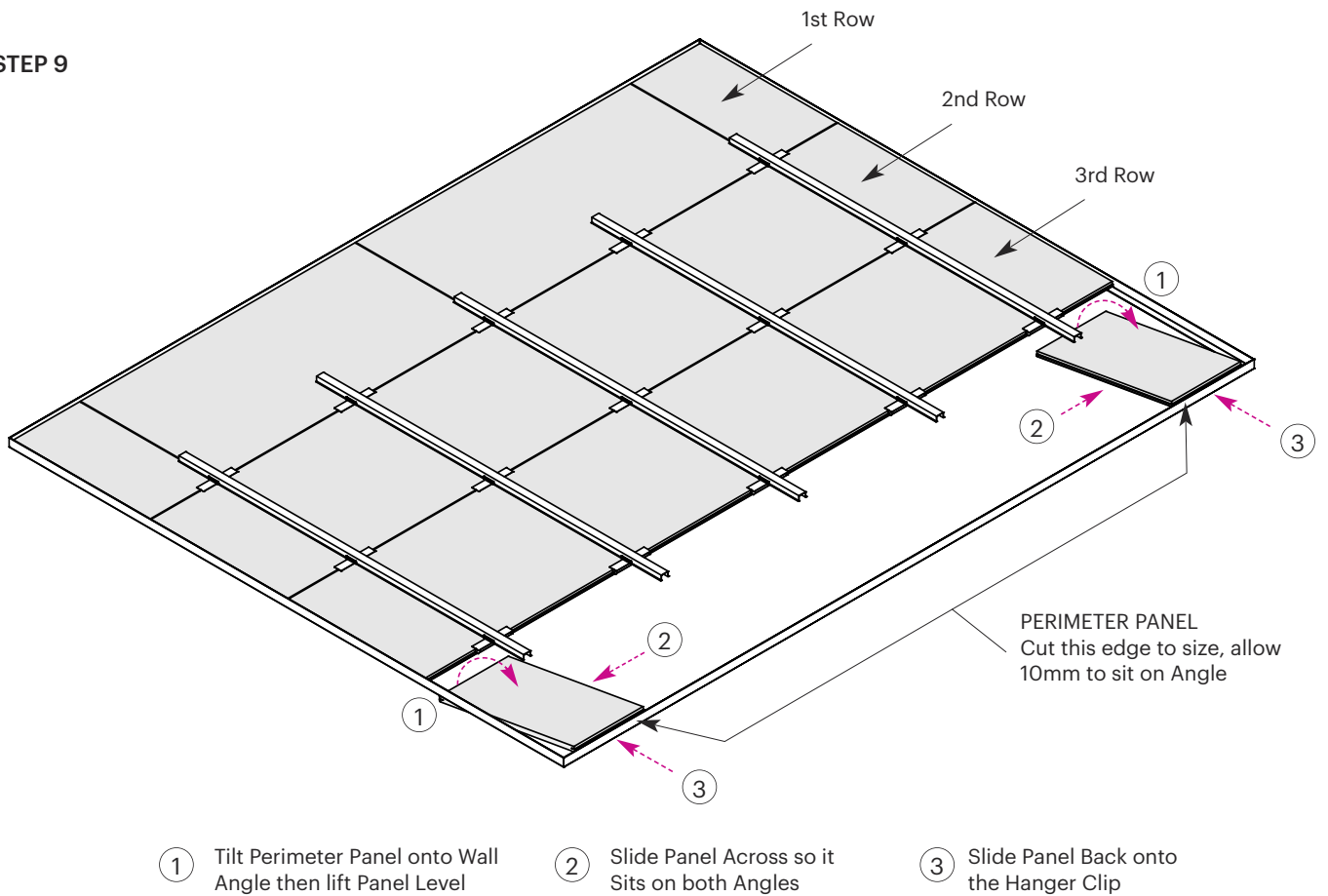

**STEP 10**

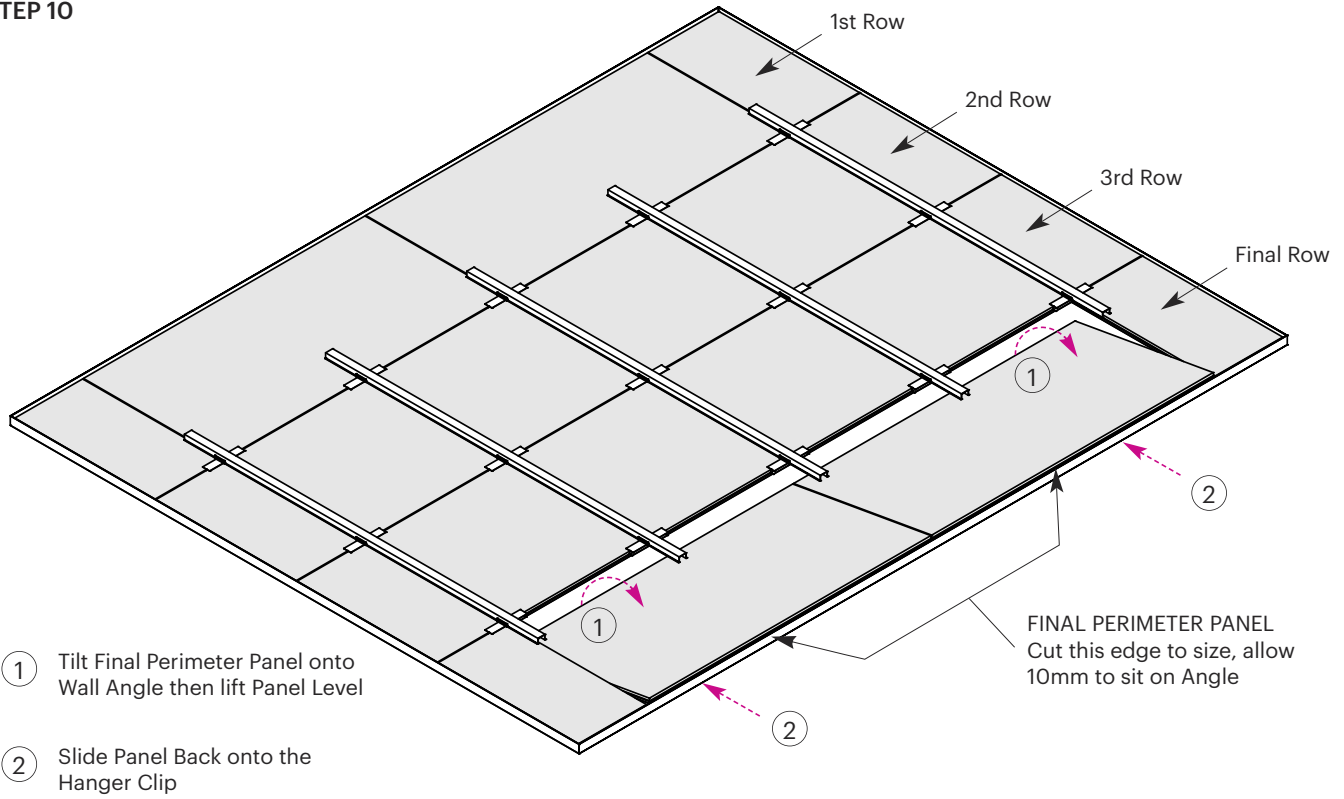

**STEP 11**

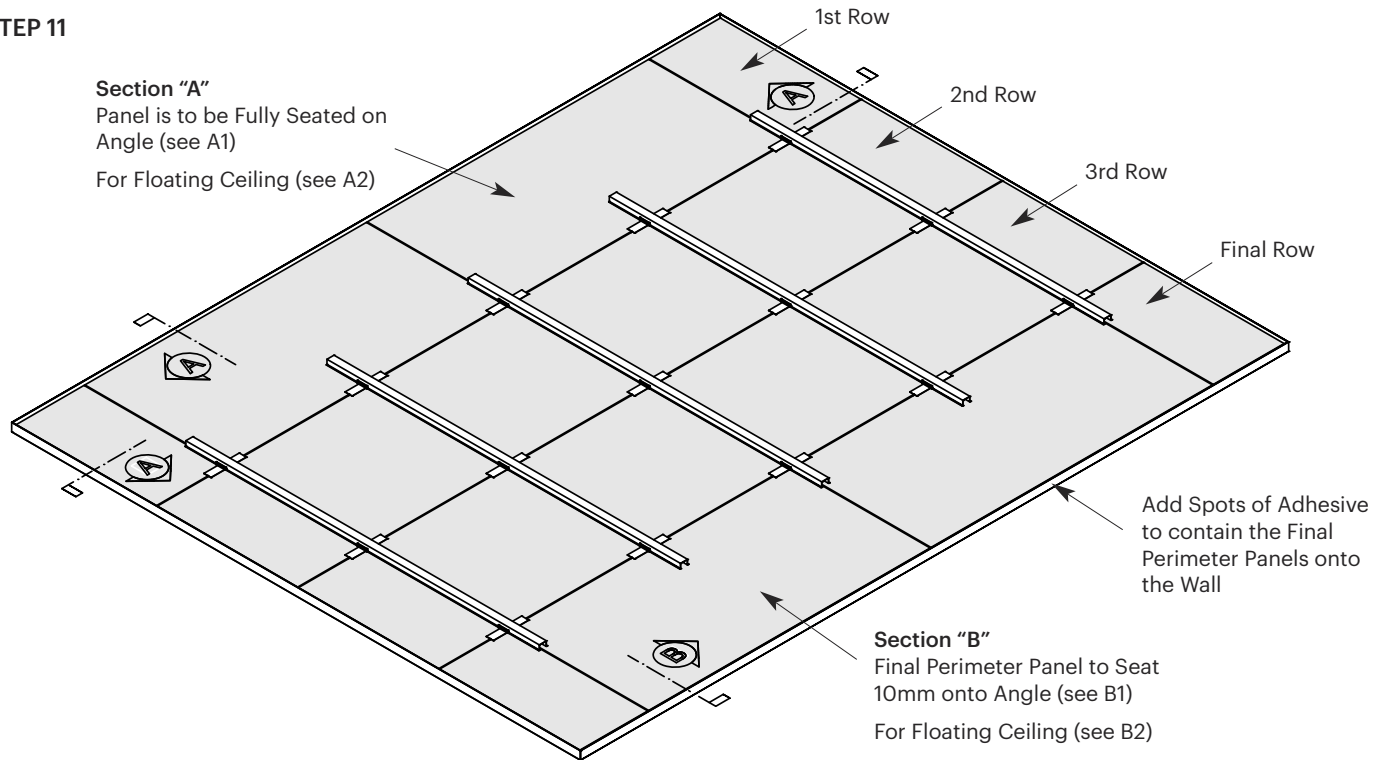

**Section "A"**

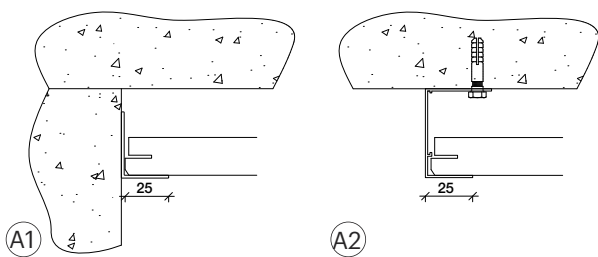

**Section "B"**

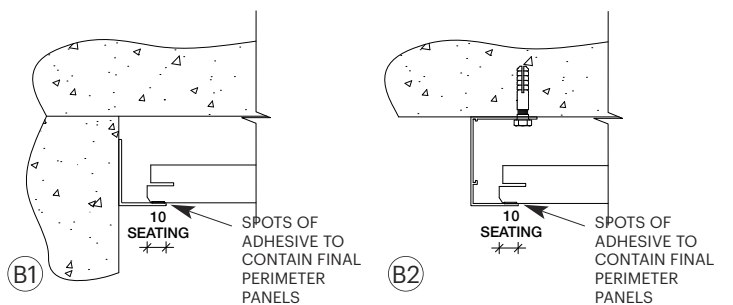

# INVISACOUSTICS: Under Slab Ceiling Panels

## 4.0 PANEL REMOVAL

Panels can be removed by reversing the procedure above.

## 5.0 CEILING PENETRATIONS

INVISACOUSTICS Panels are designed to be installed above or around major plenum services. **Note:** The acoustical panels shall not support any other material as this may effect dimensional stability.

**5.1** Penetration through the INVISACOUSTICS Panels. The Panel can be field cut for penetrations.

### 5.2 Cutting and Finishing

1. Measure the Panel penetration to the correct size required
2. Mark the Panel at the cutting location with a pencil

3. Cut through the Panel with a fine tooth saw or sharp knife
4. Apply Bond Crete to seal the exposed cut ends of the Panel and allow to dry
5. If required it may need a light sand with a fine sandpaper to remove an exposed fibres
6. Apply touch up paint to the newly cut and sealed Panel ends

## 6.0 CLEANING

Use a clean, dry, soft white cloth to wipe off any dirt or finger prints. Regular light dusting of the top side of the Panel is recommended

## MORE INFORMATION

For complete technical information, detail drawings, CAD design assistance, installation information and many other technical services, call your local Armstrong Ceilings representative.

For the latest product selection and specification data, visit [armstrongceilings.com.au](http://armstrongceilings.com.au)

## Contact us

### NSW/ACT

Armstrong Ceiling Solutions (Australia) Pty. Ltd.  
Unit 4, 1 Basalt Road, Pemulwuy NSW 2145  
Telephone (02) 9748 1588

### VIC/TAS

Armstrong Ceiling Solutions (Australia) Pty. Ltd.  
Unit 1, 88 Henderson Road, Rowville VIC 3178  
Telephone (03) 8706 4000

### QLD / NT

Armstrong Ceiling Solutions (Australia) Pty. Ltd.  
6 Barrinia Street, Slacks Creek QLD 4127  
Telephone (07) 3809 5565

### SA

Total Building Systems Pty. Ltd.  
160 Grand Junction Road, Blair Athol SA 5084  
Telephone (08) 7325 7555

### WA

Ceiling Manufacturers of Australia Pty. Ltd.  
3 Irvine Street, Bayswater WA 6053  
Telephone (08) 9271 0777

### New Zealand

Forman Building Systems Ltd.  
27B Smales Road, East Tamaki, Auckland 2013  
Telephone 64-9-276 4000

