

Product Data Sheet

GreenGuard® GG300

Insulation for Inverted Roofs, Basements, Car Park Decks, and Heavy Duty Commercial, Industrial, and Cold Store Flooring

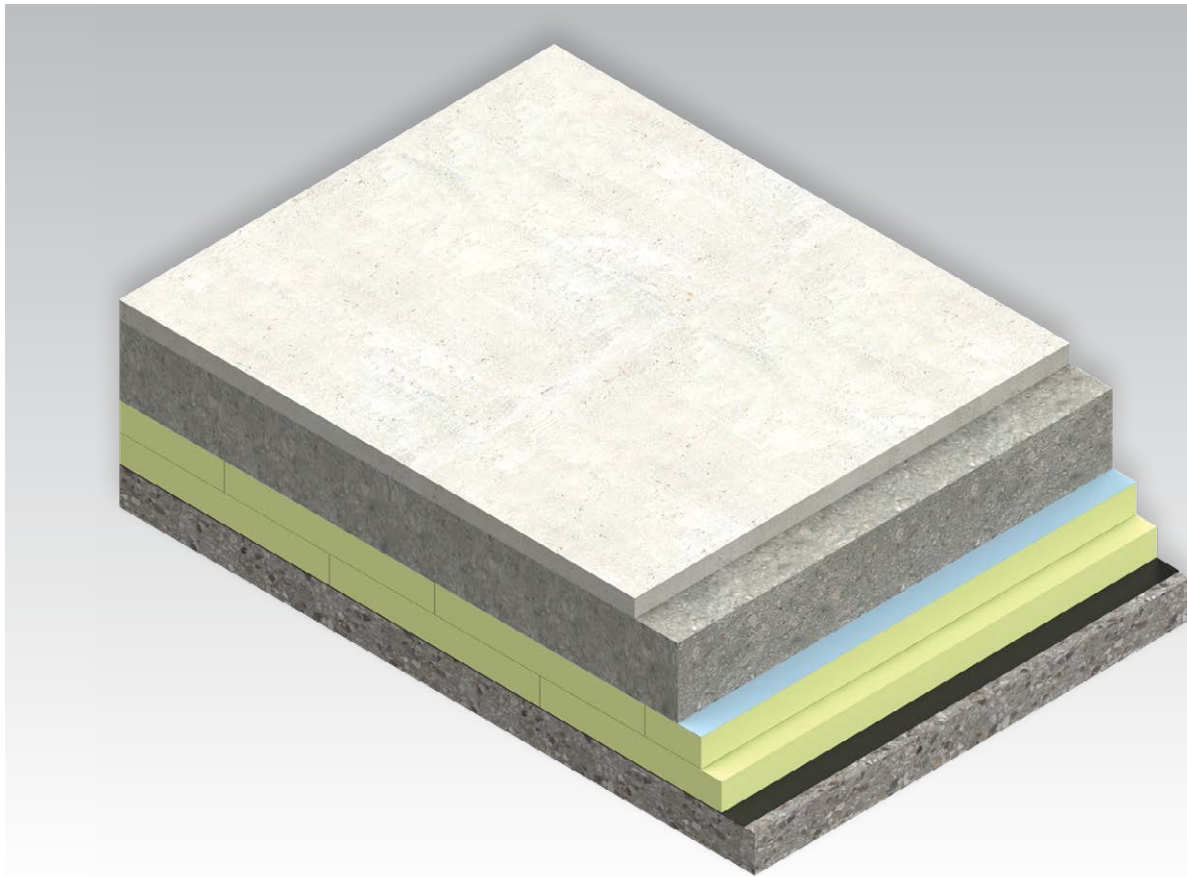

GreenGuard® GG300

Product Description

Kingspan GreenGuard®

Kingspan GreenGuard® GG300 is an extruded polystyrene (XPS) insulant with a fibre-free core.

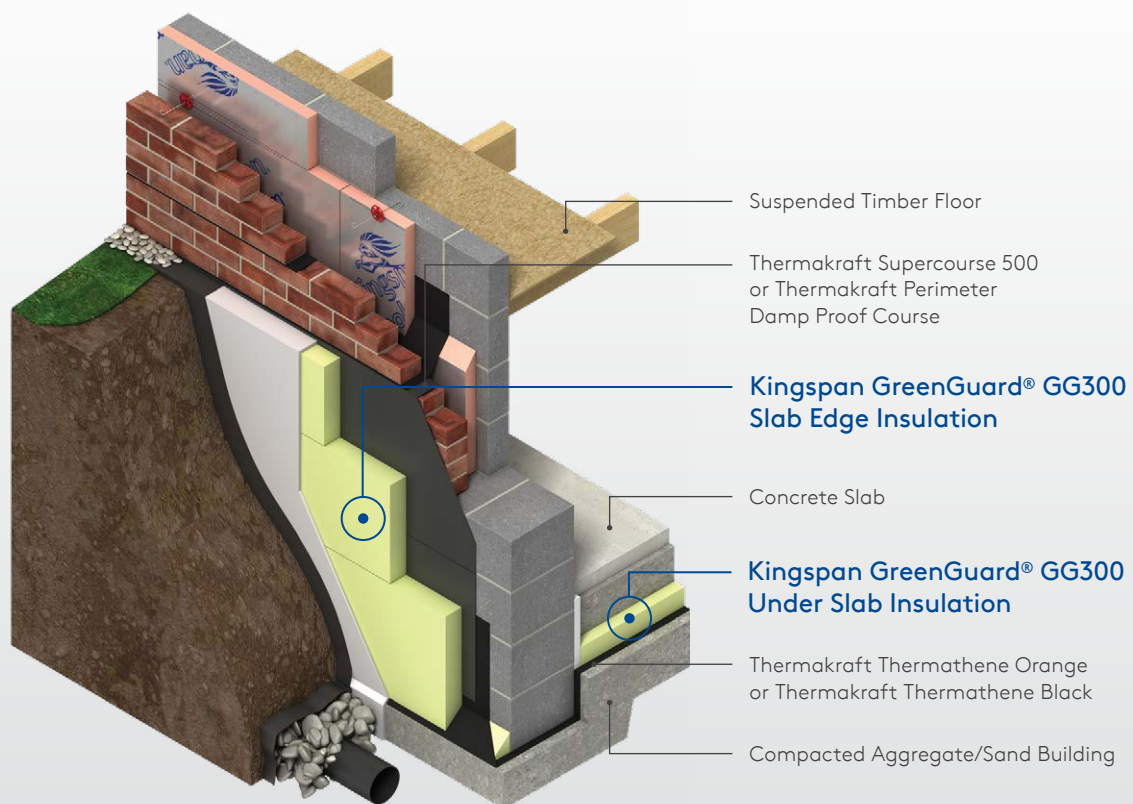

Figure 1. Kingspan GreenGuard GG300.

- Rigid extruded polystyrene insulation
- Protects waterproofing membrane
- Compatible with most green roof systems
- Easy to handle and install
- Ideal for new build and refurbishment
- Manufactured with a blowing agent that has zero ODP
- NZBC and AS/NZS 4859.1:2018 compliant

Fibre-free
Core

GreenGuard® GG300

Product Performance Data

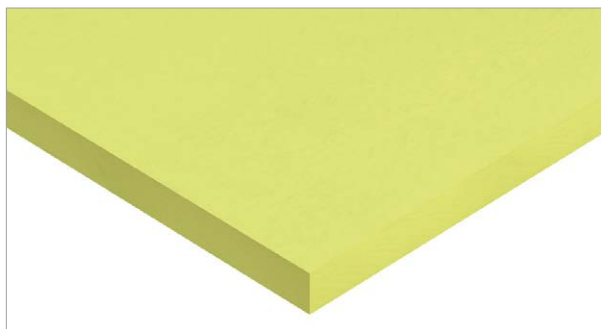

Figure 2. Kingspan GreenGuard GG300.

Scope of Use

Kingspan GreenGuard GG300 can be used in the following applications:

- Green roof and inverted flat roof systems
- Under slab and tanking

General

- NZBC and AS/NZS 4859.1:2018 compliant.
- Fibre-free, closed cell insulation core.
- GreenGuard GG300 is not subject to a warning or ban under section 26 of the Building Act 2004 when used as per the product scope.
- GreenGuard GG300 is made in Vietnam.

Limitations

- Cannot be permanently exposed to weather elements.
- Check adhesive or membrane compatibility with the tanking system provider.
- Must NOT be used as a wall or HVAC ducting insulation material.

Resistance to Solvents, Fungi & Rodents

Kingspan GreenGuard is resistant to most commonly occurring construction materials such as lime, cement, plaster, anhydrous gypsum, solvent-free bituminous compounds, water-based wood preservatives, as well as alcohols, acids and alkalis. Certain organic materials such as solvent-based preservatives, coal tar and derivatives (creosote), paint thinners and common solvents (e.g. acetone, ethyl acetate, petrol, toluene and white spirit) will attack Kingspan GreenGuard, resulting in softening, shrinkage and possible dissolution, with a consequent loss of performance.

Kingspan GreenGuard does not provide any food value to vermin and does not promote infestation.

Cutting

Cutting should be carried out either by using a fine toothed saw, a hot wire system or by scoring with a sharp knife and snapping the board over a straight edge. Ensure accurate trimming to achieve close-butting joints and continuity of insulation.

Packaging and Storage

The polyethylene packaging of Kingspan Insulation products, which is recyclable, should not be considered adequate for outdoor protection. GreenGuard should be protected from exposure to direct sunlight. If, however, outside storage cannot be avoided, then the boards should be stacked clear of the ground and covered with an opaque polythene sheet or weatherproof tarpaulin.

Boards should not be left in the sun covered by either a transparent or a dark plastic sheet, since in both cases, board temperatures can build up to a level hot enough to appreciably alter board dimensions or cause warping.

WARNING: This product is combustible. Protect it from exposure to open flame or other ignition sources during shipping, storage and installation.

Health and Safety

Kingspan Insulation products are chemically inert and safe to use. A Safety Information Data Sheet for this product is available on request.

WARNING: Do not stand on or otherwise support your weight on this product unless it is fully supported by a load bearing surface.

Standards & Approvals

Kingspan GreenGuard is manufactured to the highest standards under a management system certified to ISO 9001:2015.

Kingspan GreenGuard is tested and labelled in accordance with AS/NZS 4859.1:2018.

Property	Kingspan GreenGuard GG300
Compressive Strength (kPa)	≥ 300
Lambda (W/m.K) at 15°C as per AS/NZS 4859.1:2018	0.037
Blowing Agent	CO ₂ and Ethanol
Nominal Density (kg/m ³)	35
Product Dimensions	2770 mm x 600 mm
GreenGuard should be protected from exposure to direct sunlight.	

Product R-Value

Nominal Product Thickness	Declared Product R-value at 15°C
50mm	R1.35
60mm	R1.65
70mm	R1.90
80mm	R2.20
90mm	R2.45
Lambda and declared product R-values at 15°C as per AS/NZS 4859.1:2018. For further information and non-stocked sizes please contact info@kingspaninsulation.co.nz	



Product Warranty

Standard Kingspan Insulation Warranty applies. Refer to Kingspan Insulation Warranty statement for further details. This is available online at [kingspaninsulation.co.nz](https://www.kingspaninsulation.co.nz); or call us on 0800 806 595; or email info@kingspaninsulation.co.nz

Kingspan Insulation NZ Limited (NZBN 9429045930393), reserves the right to amend product specifications without prior notice. The information contained in Kingspan's literature is given in good faith and based on good building practice but are not an exhaustive statement of all relevant information and are subject to any conditions contained in the Warranty. Recommendations for use should be verified as to the suitability and compliance with actual requirements, specifications and any applicable laws and regulations. All product dimensions and performance claims are subject to any variation caused by normal manufacturing process and tolerances.

Furthermore, as the successful performance of the relevant system depends on numerous factors outside the control of Kingspan (for example quality of workmanship and design), Kingspan shall not be liable for the recommendations in that literature and the performance of the Product. For other applications or conditions of use, Kingspan Insulation offers a Technical Advisory Service, the advice of which should be sought for uses of Kingspan Insulation products that are not specifically described herein. Please check that your copy of the literature is current by contacting us or visiting www.kingspaninsulation.co.nz E&OE

